

Projeto técnico para equipamento de mobiliário urbano, promoção e sinalização das Terras de Trás-os-Montes.

Comunidade Intermunicipal
Terras de Trás-os-Montes

Desenhos Técnicos 06.10.2023

Técnico Responsável
Carlos Pereira-Designer Industrial
carlospereira@induse.com
+351 913 040 408

Induse Design Industrial Lda.® 2023

INDS_CIM_TTM_MBo1A

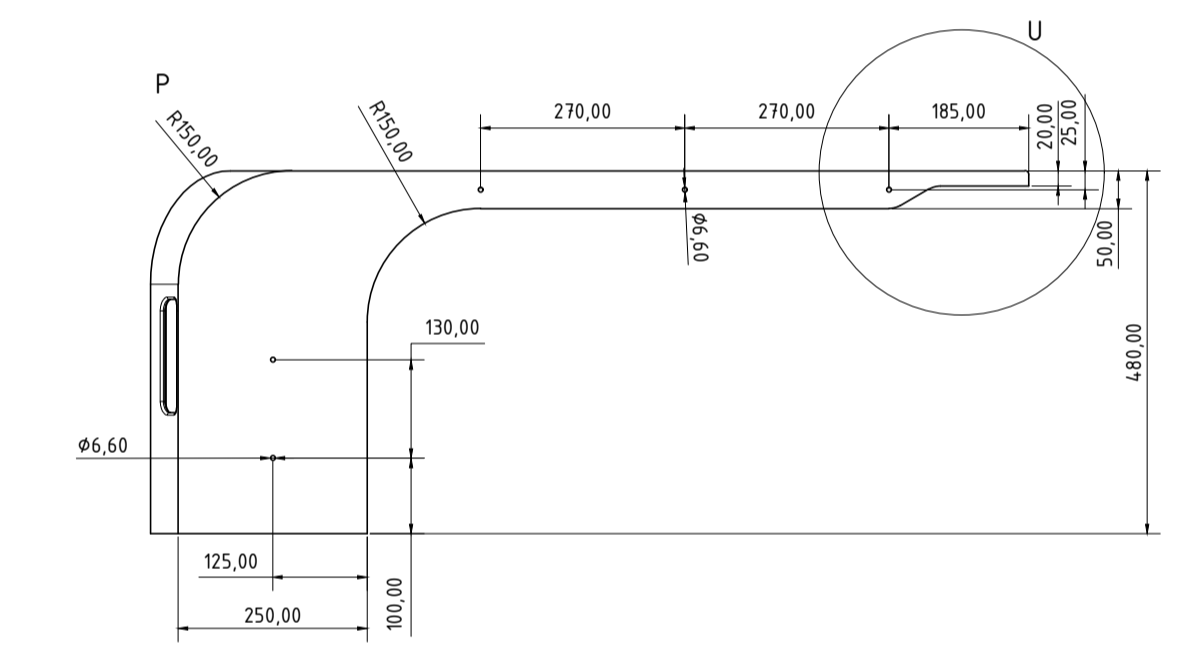
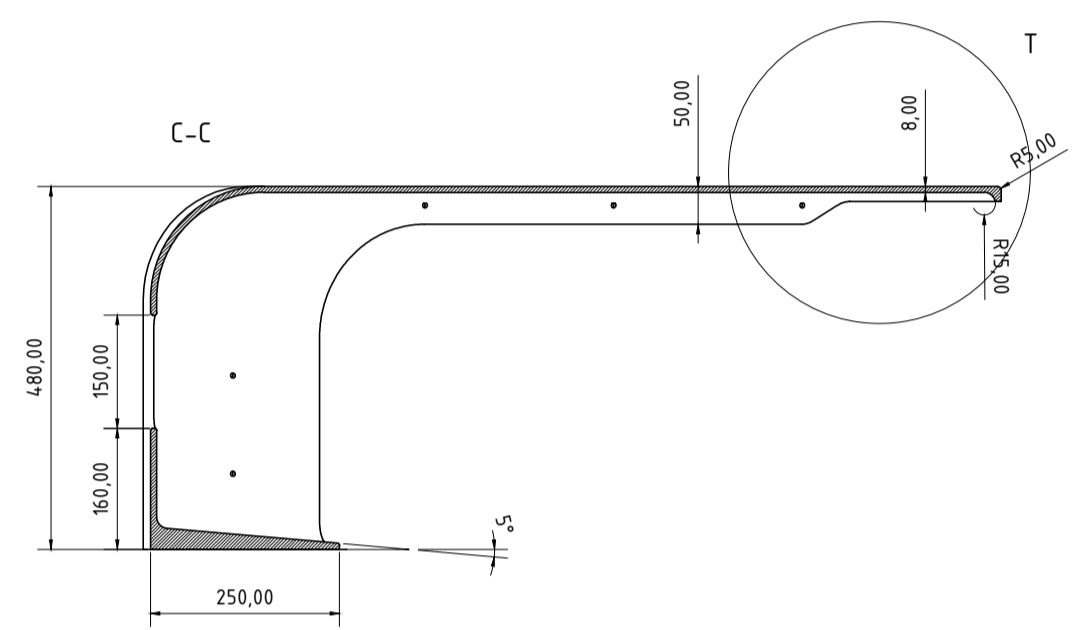
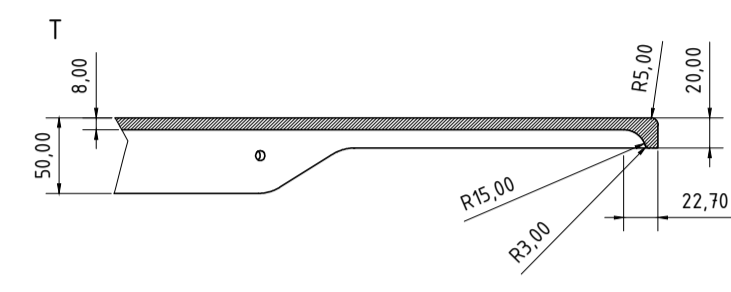
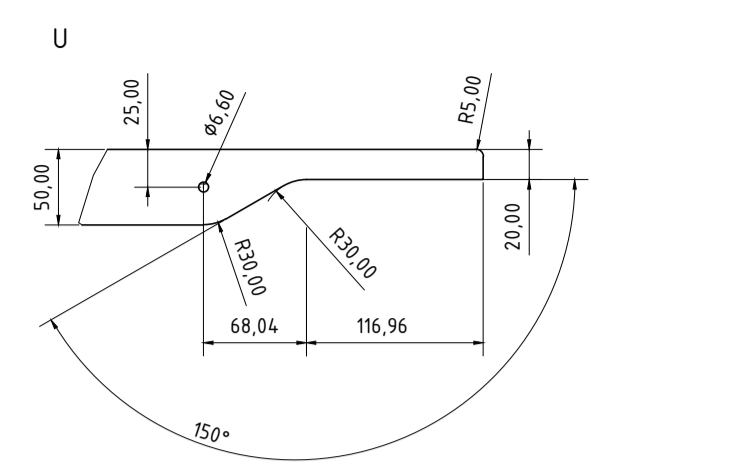
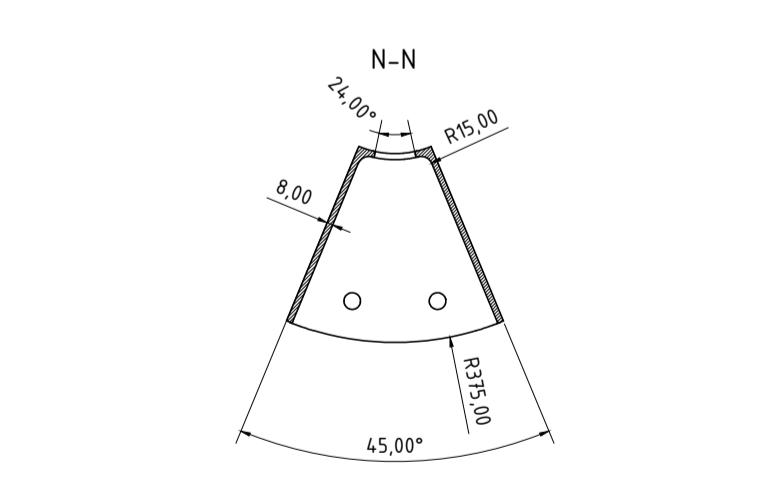
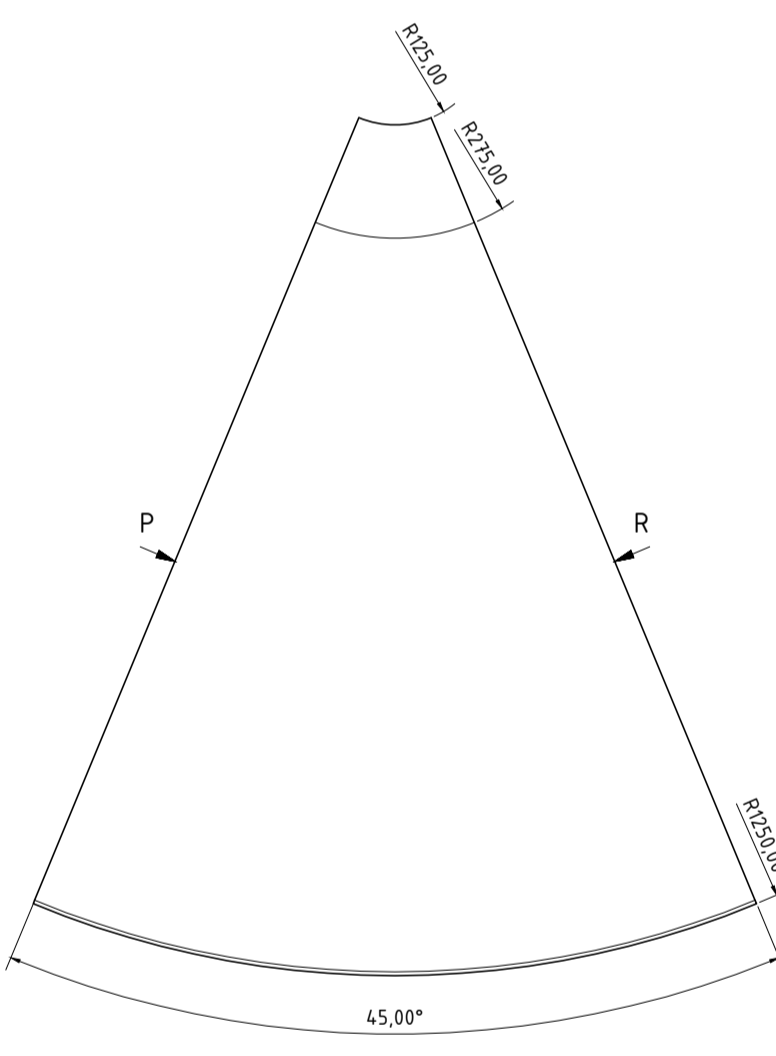
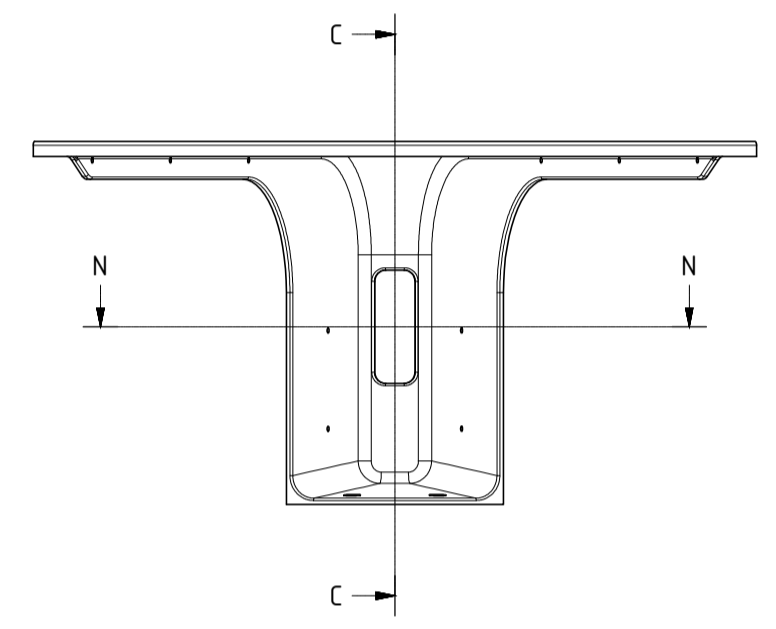
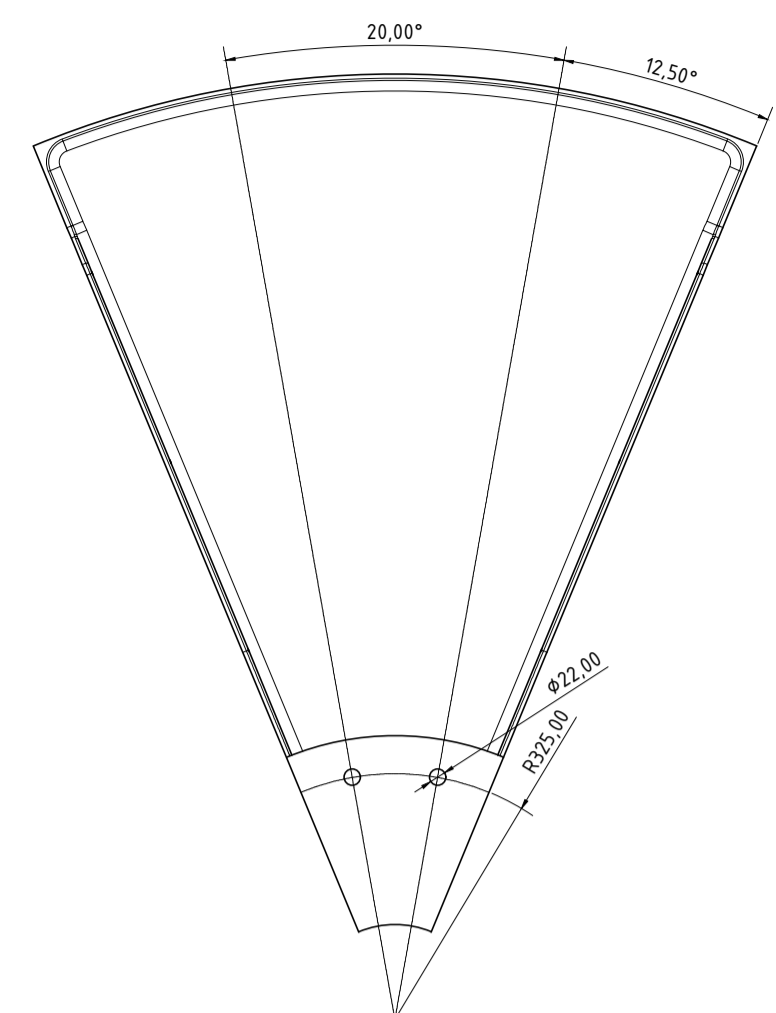

INDS_CIM_TTM_MBo2A

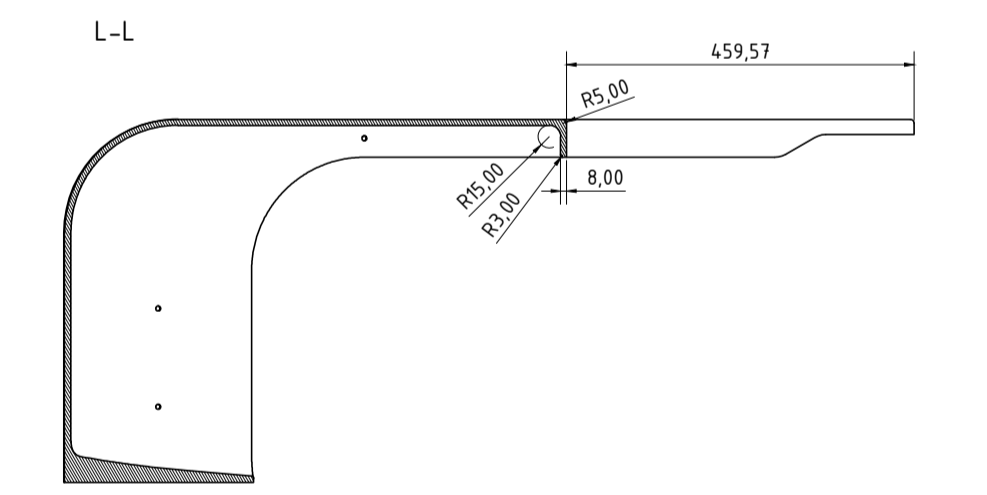
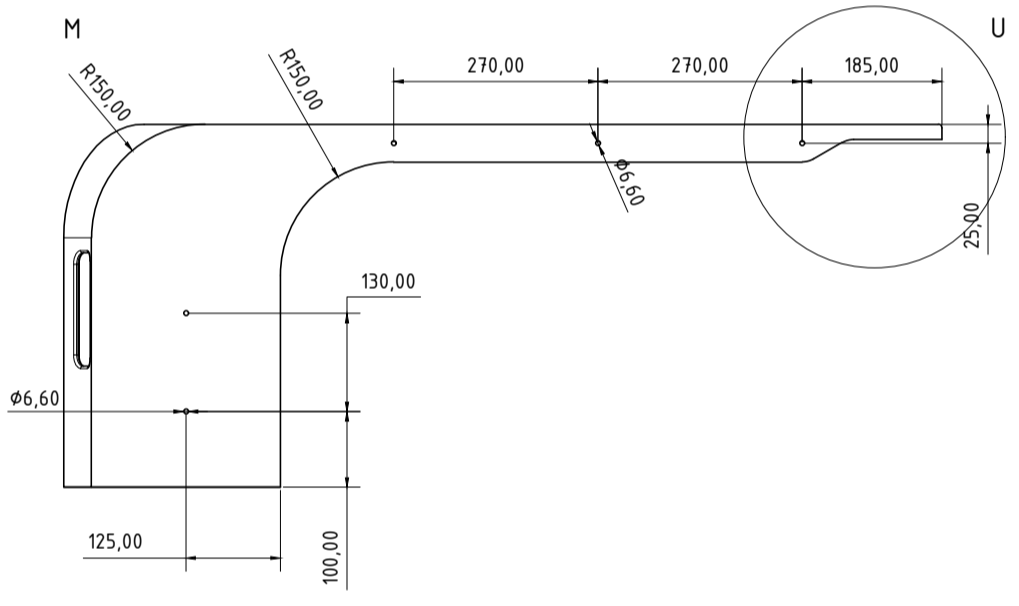
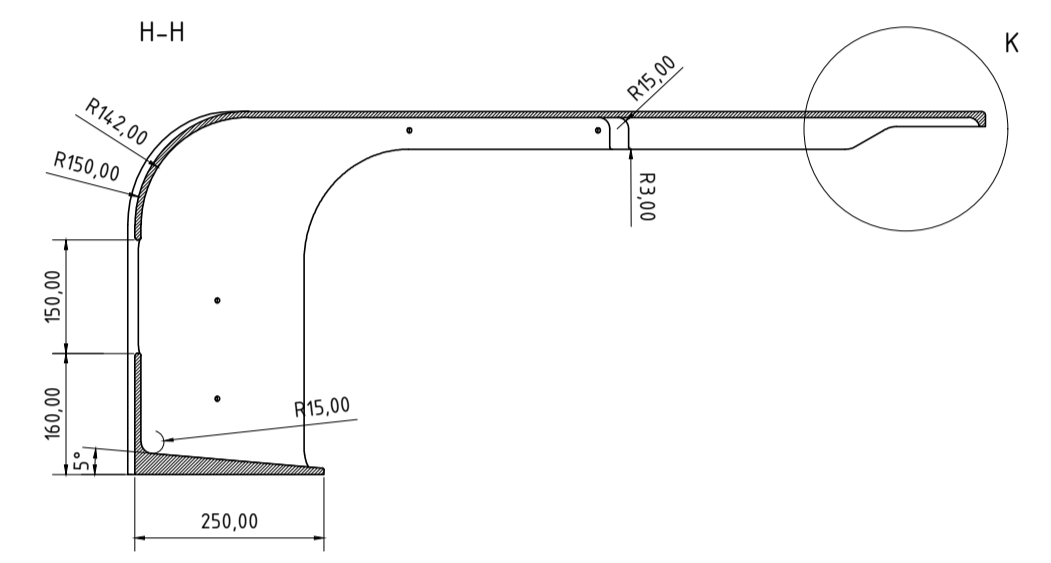
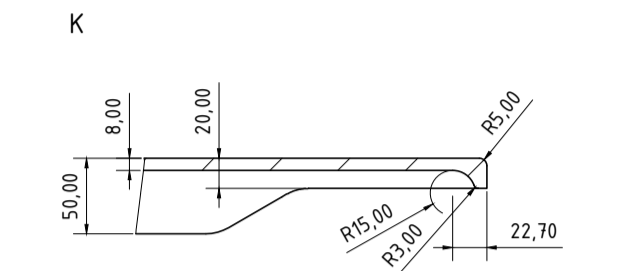
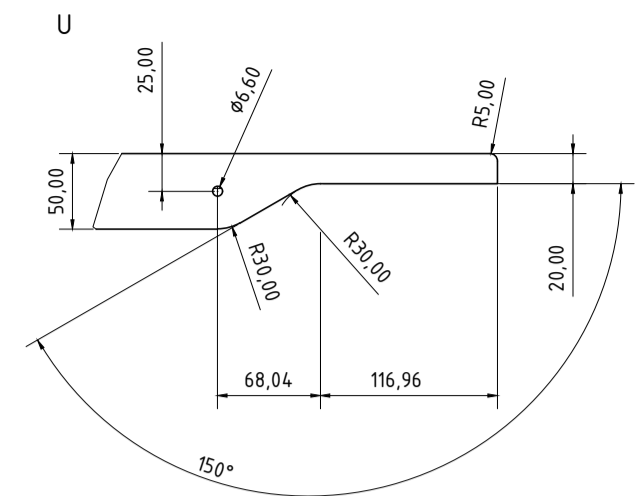
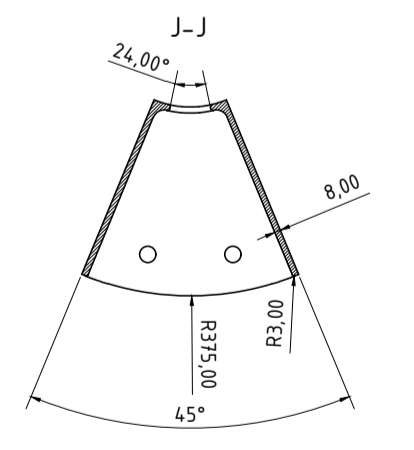
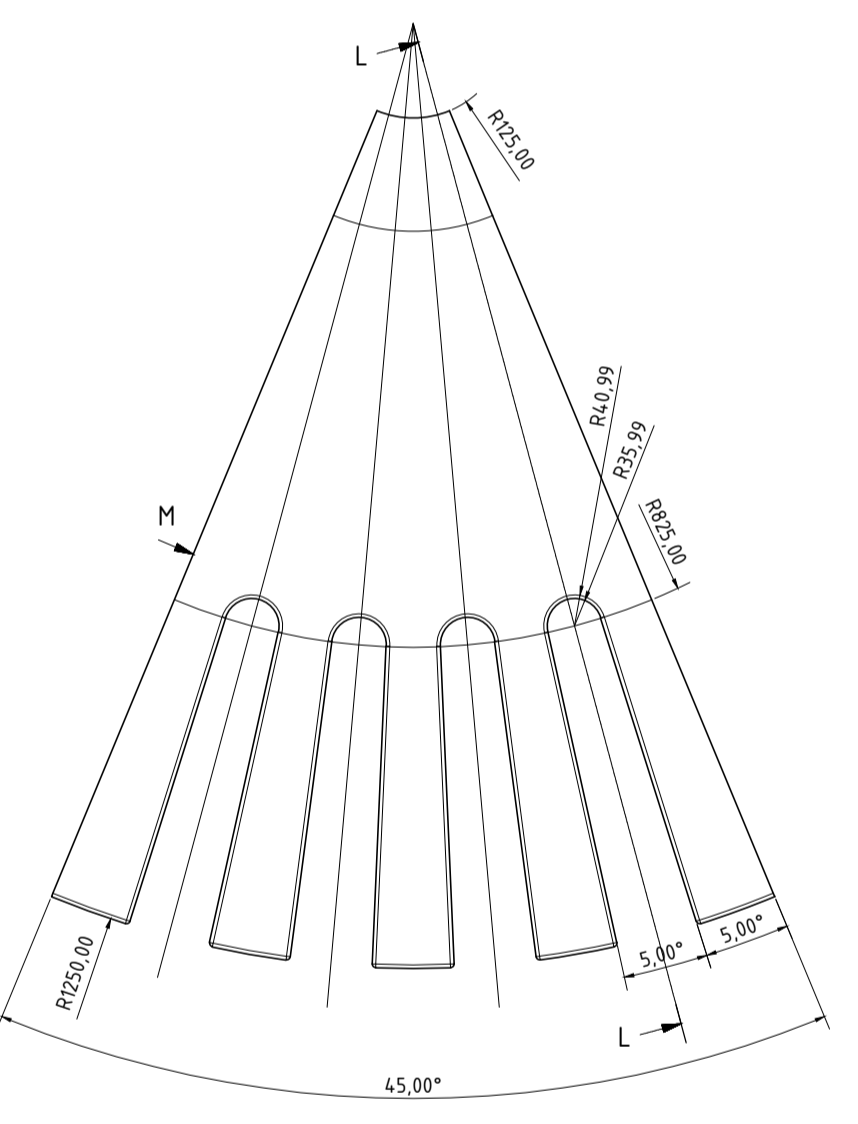
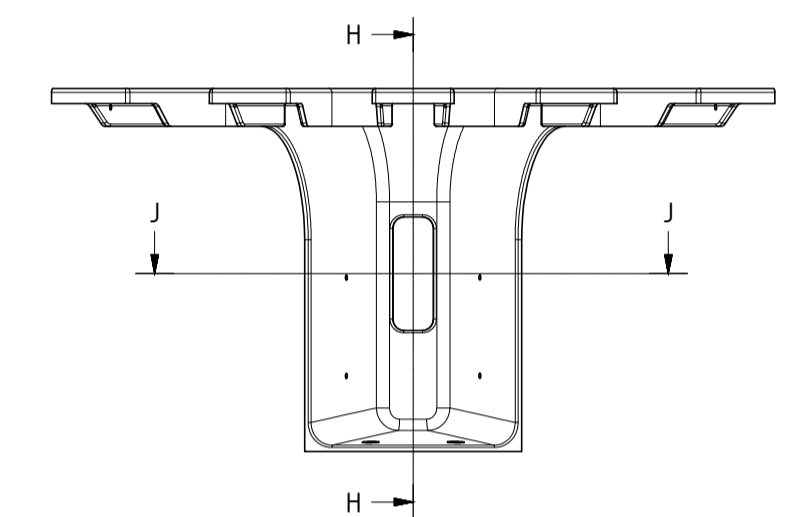
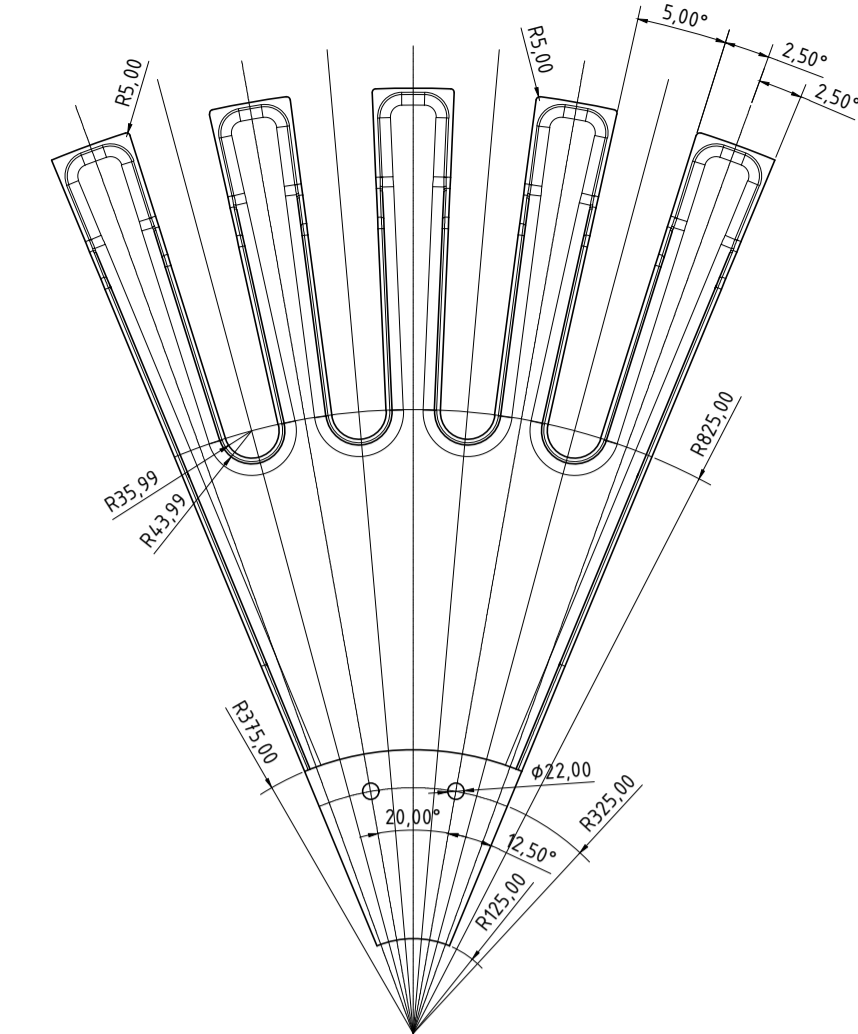

INDS_CIM_TTM_MBo1

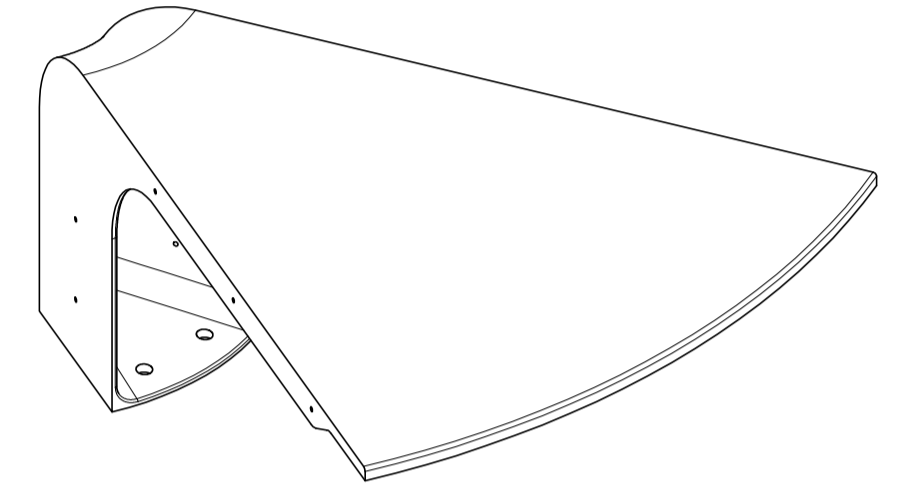
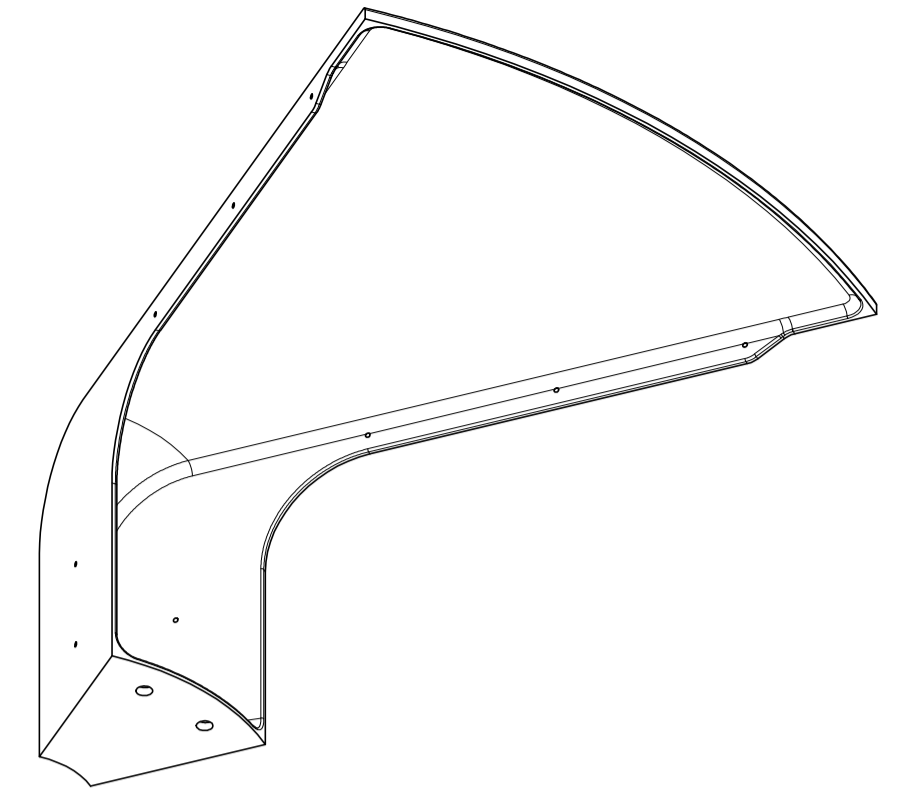

INDS_CIM_TTM_MBo2

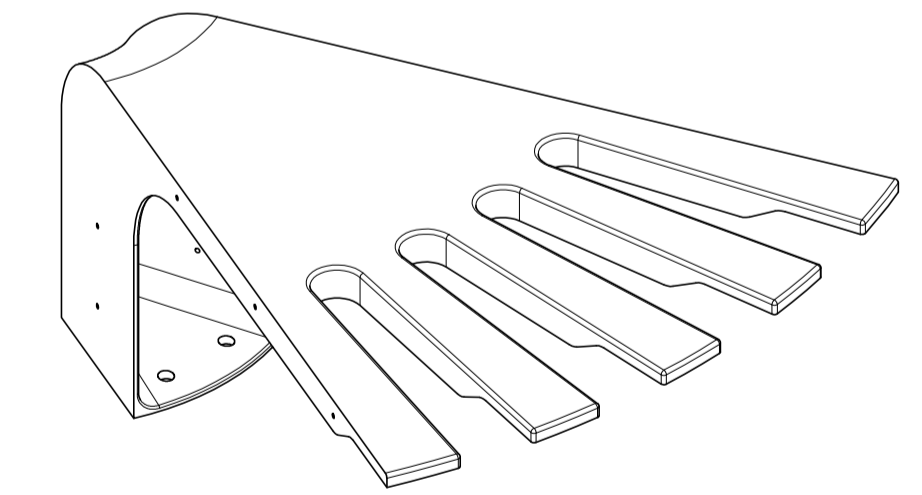
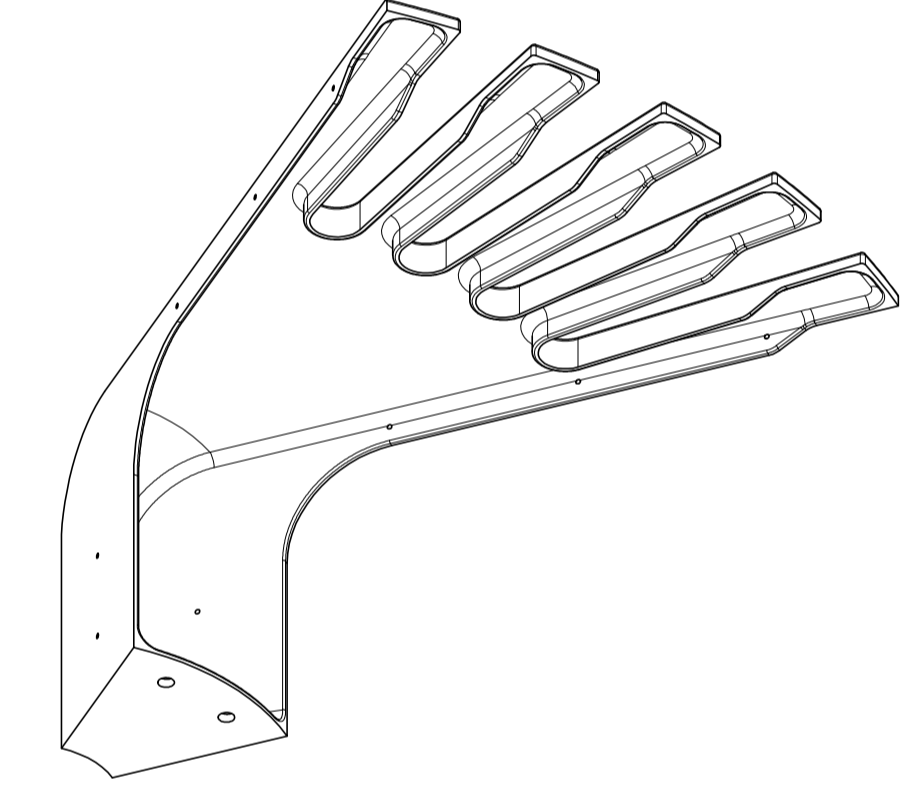

QUANT.	DESIGNAÇÃO	Nº NORMA Nº DO DESENHO	MATERIAL	Nº REF. Nº DE MOLDA/MATRIZ	PESO	OBSERVAÇÃO
18	INDS_CIM_TTM_MBo2		Alumínio Fundição areia	granalhado fino		Maqüinação CNC
54	INDS_CIM_TTM_MBo1		Alumínio Fundição areia	granalhado fino		Maqüinação CNC

PRAL	CIM_TTM_01A	ESC	1:10
DATA	04.10.23	TRC	Carlos Pereira

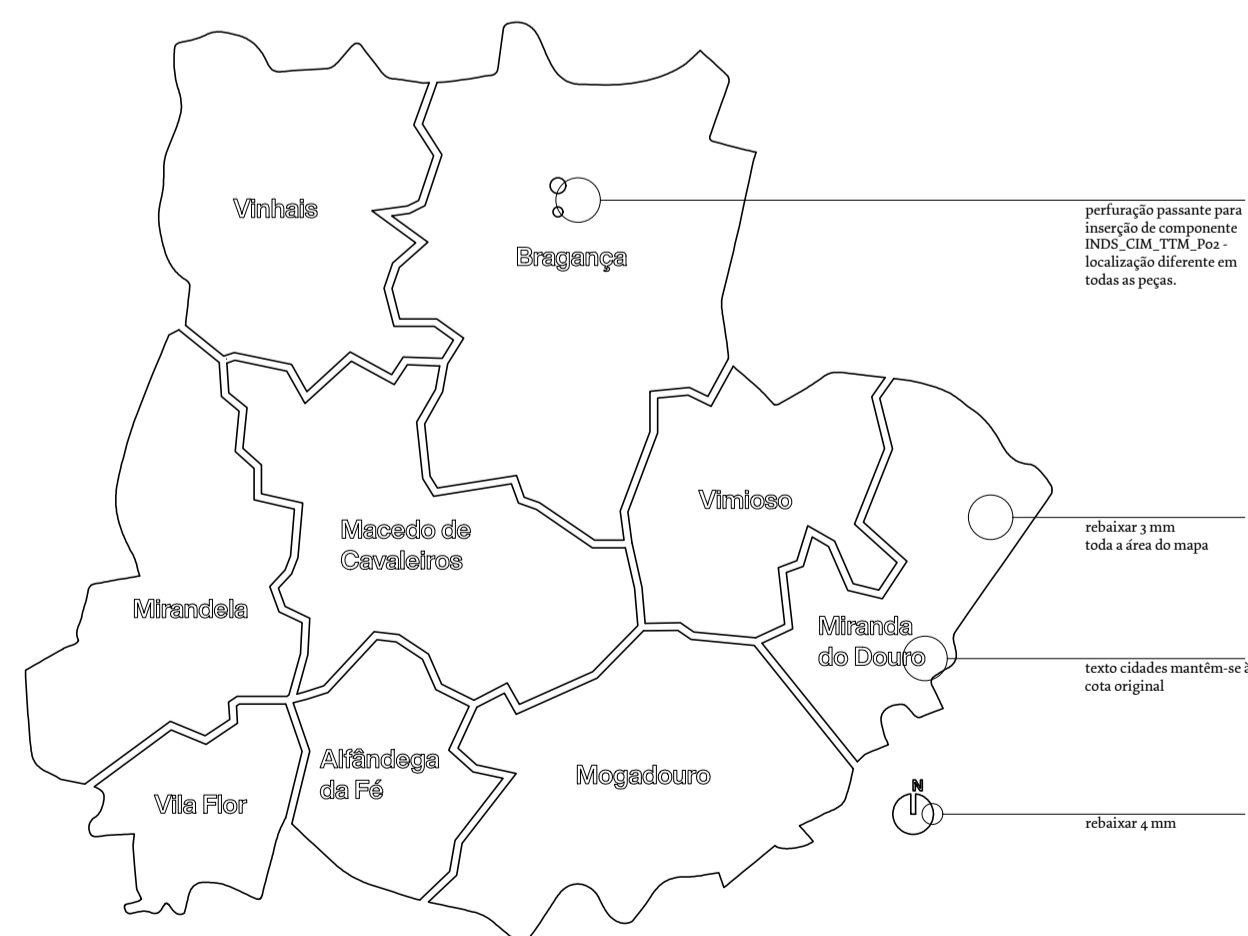
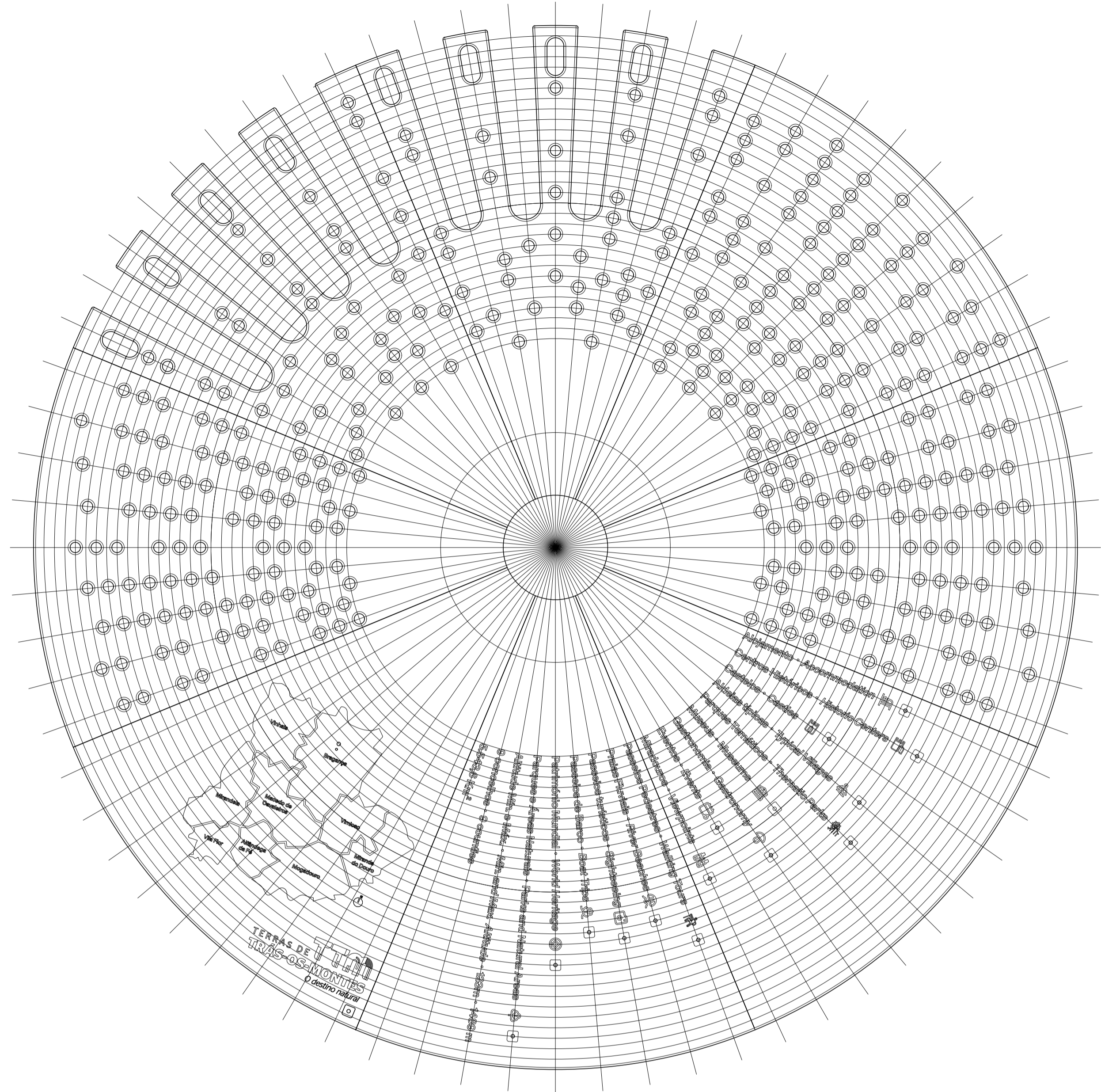
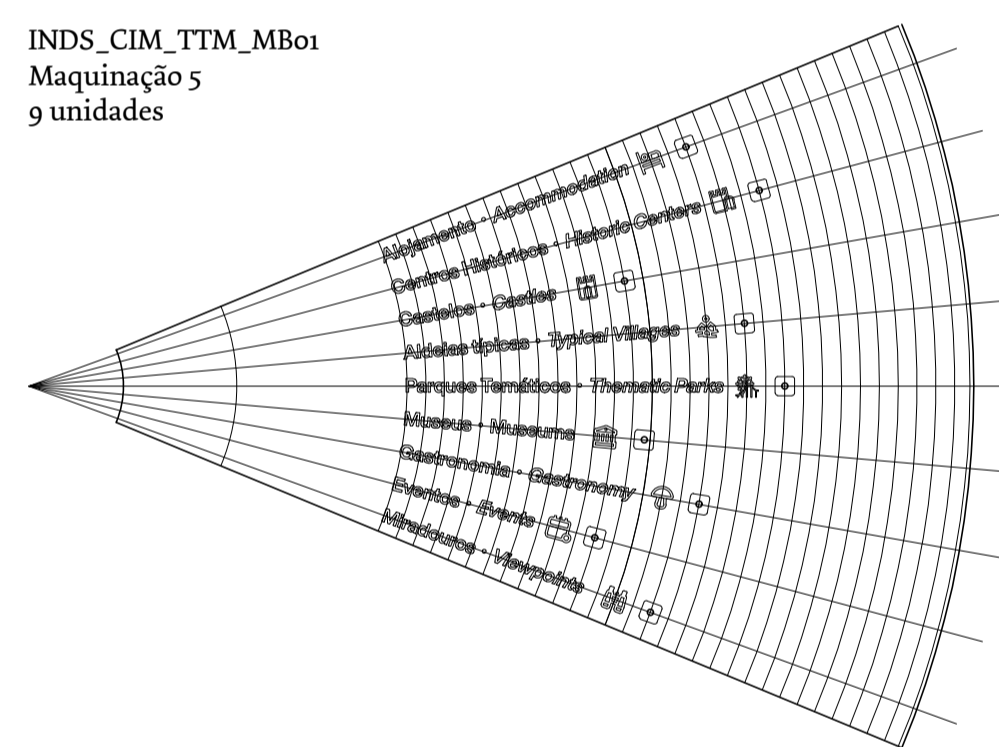
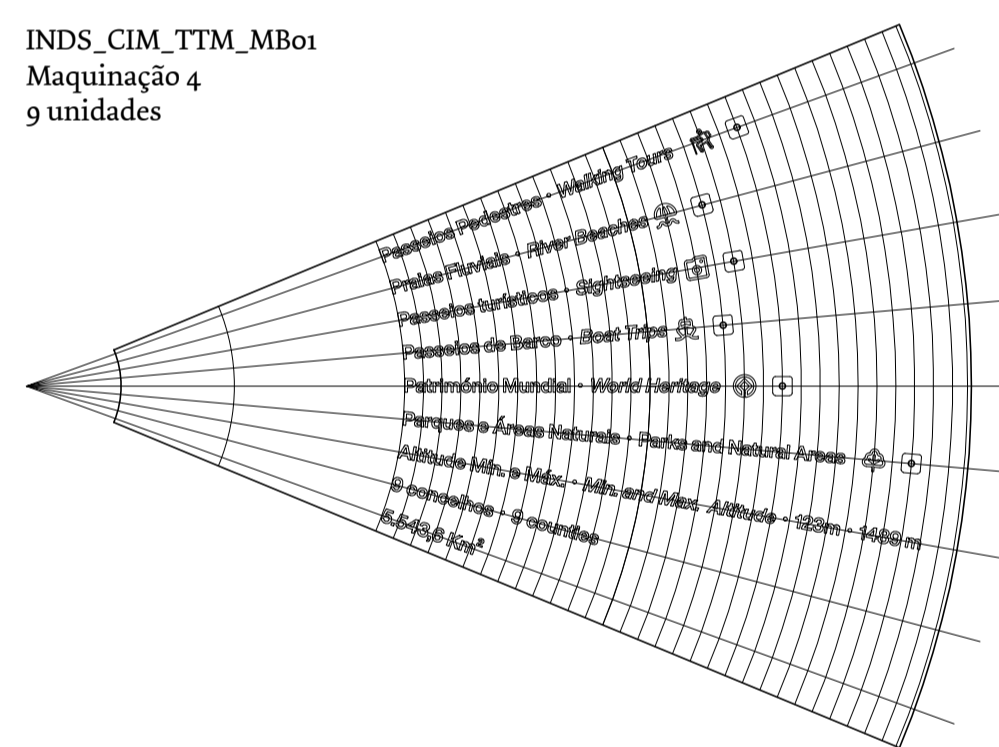
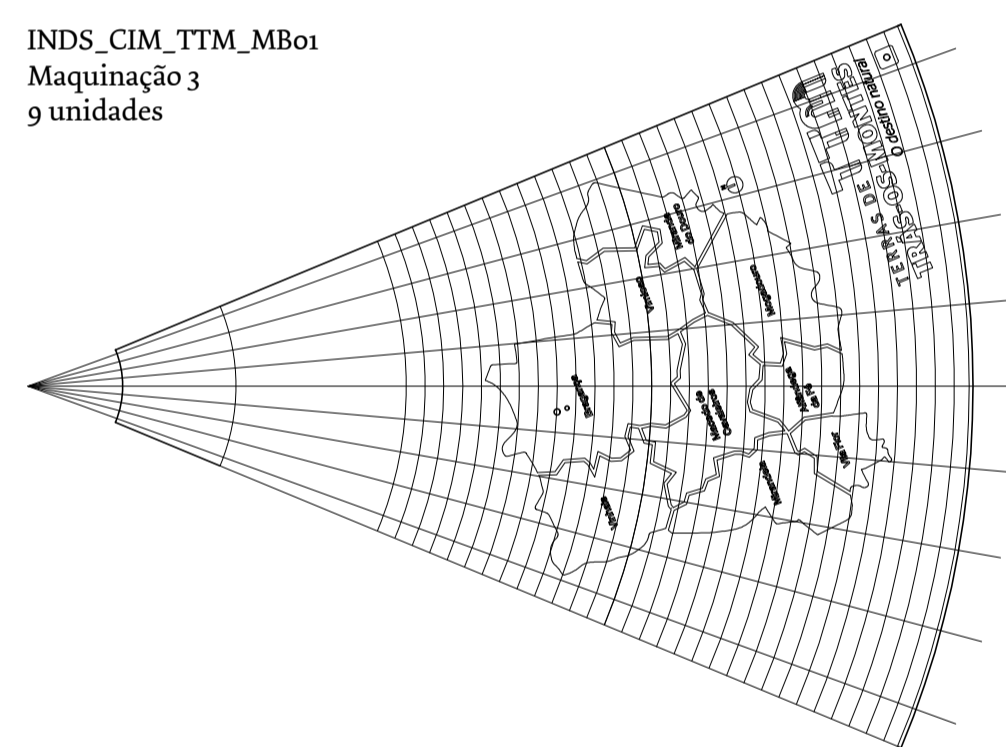
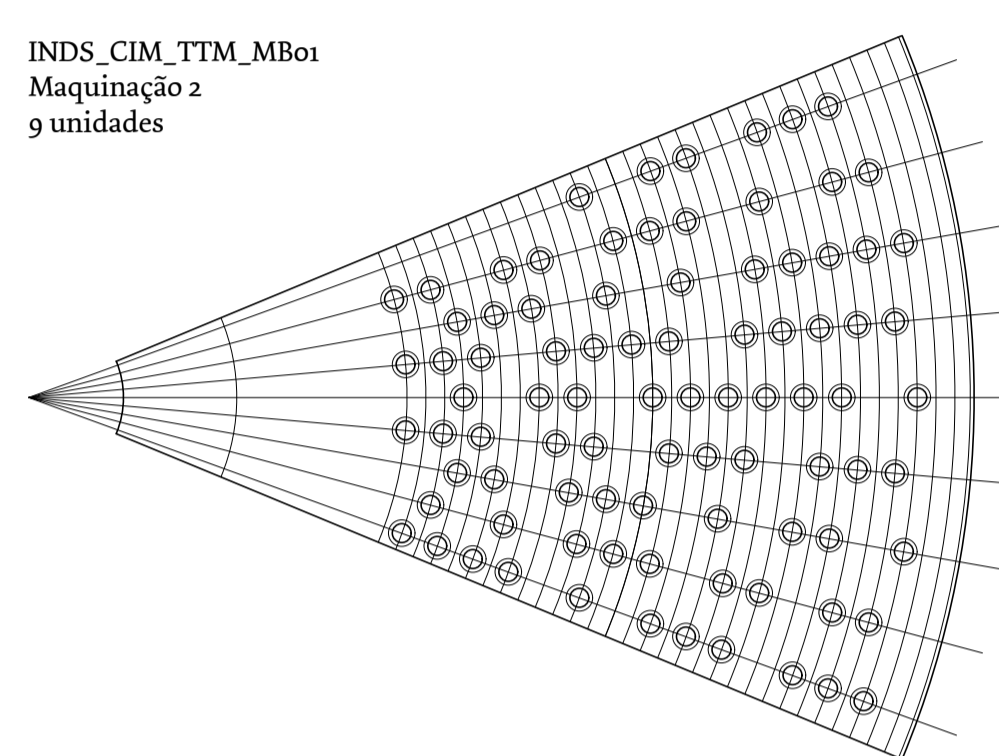
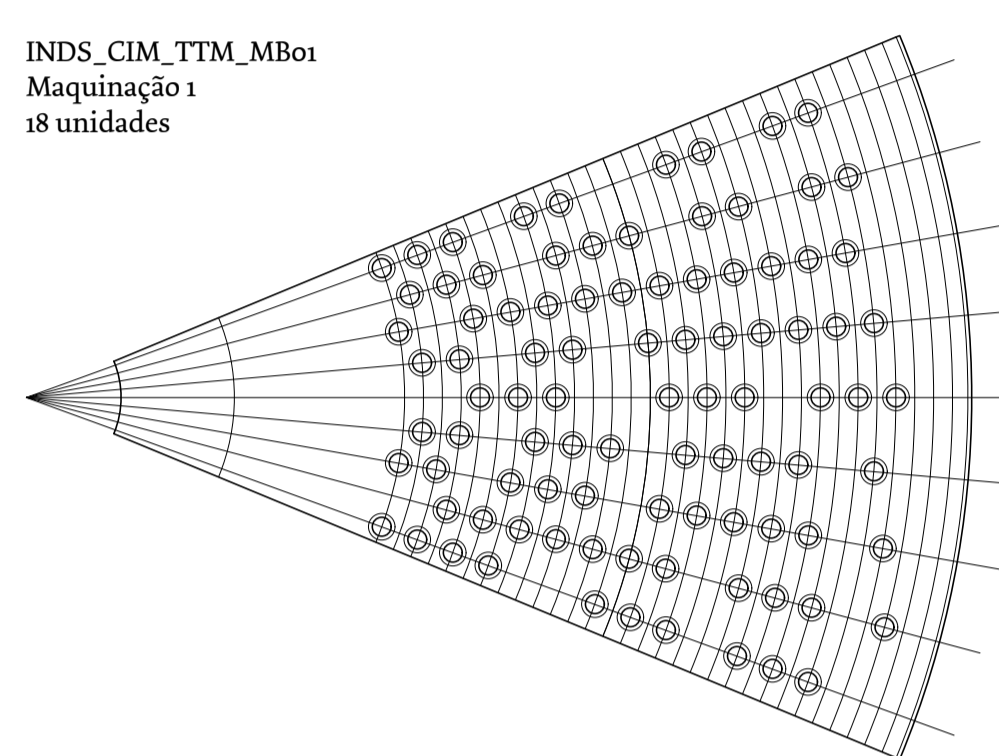
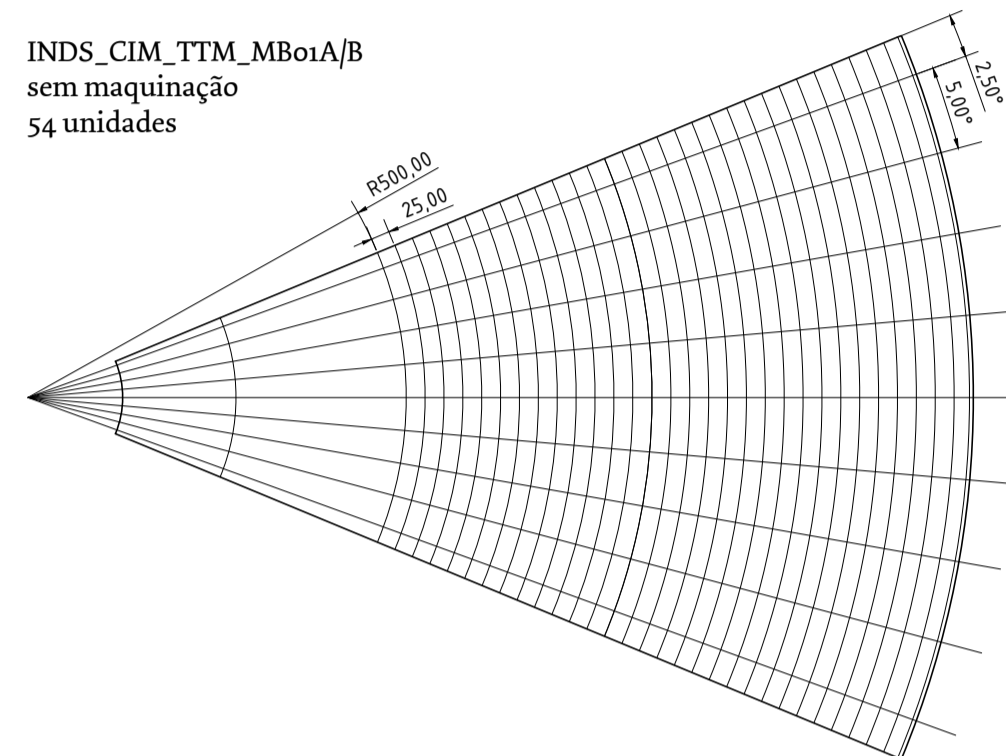
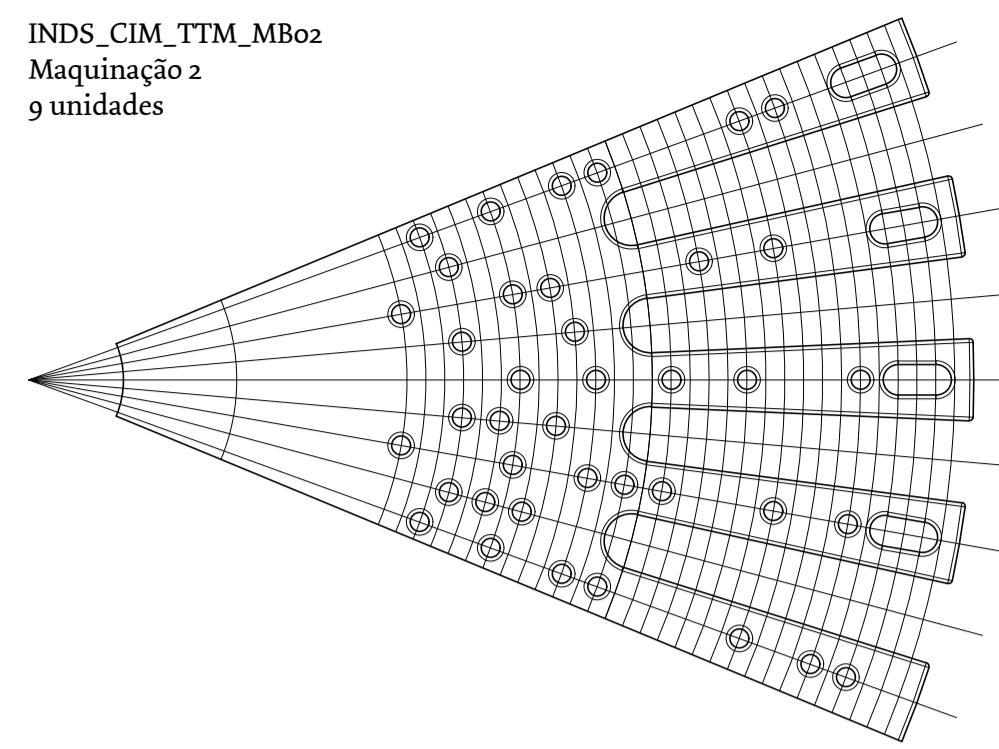
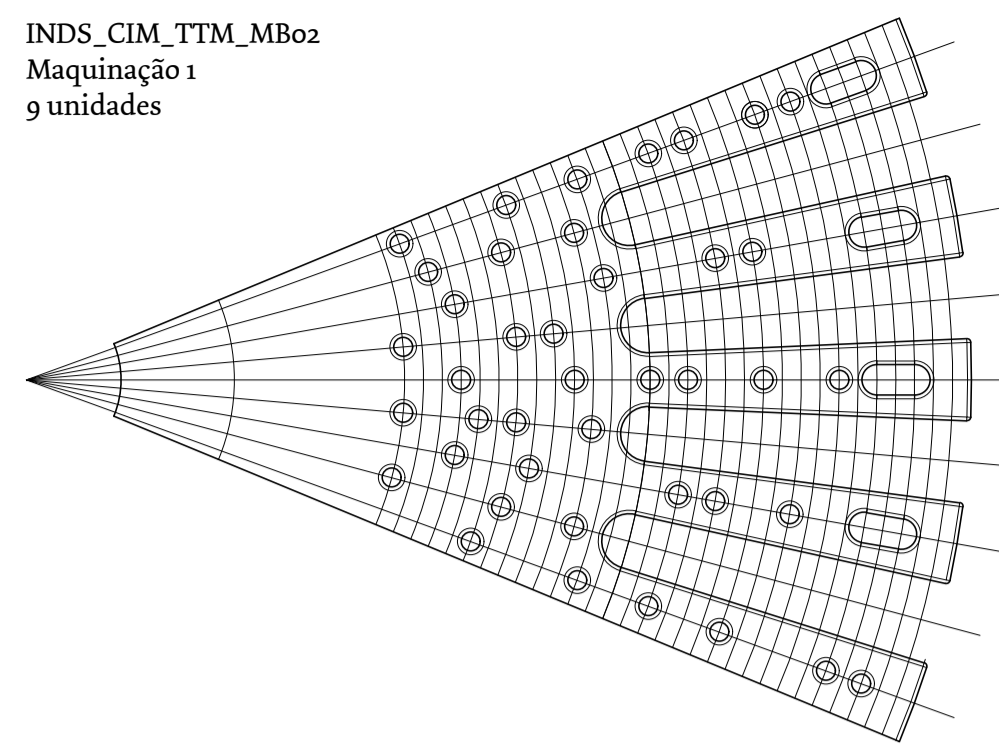
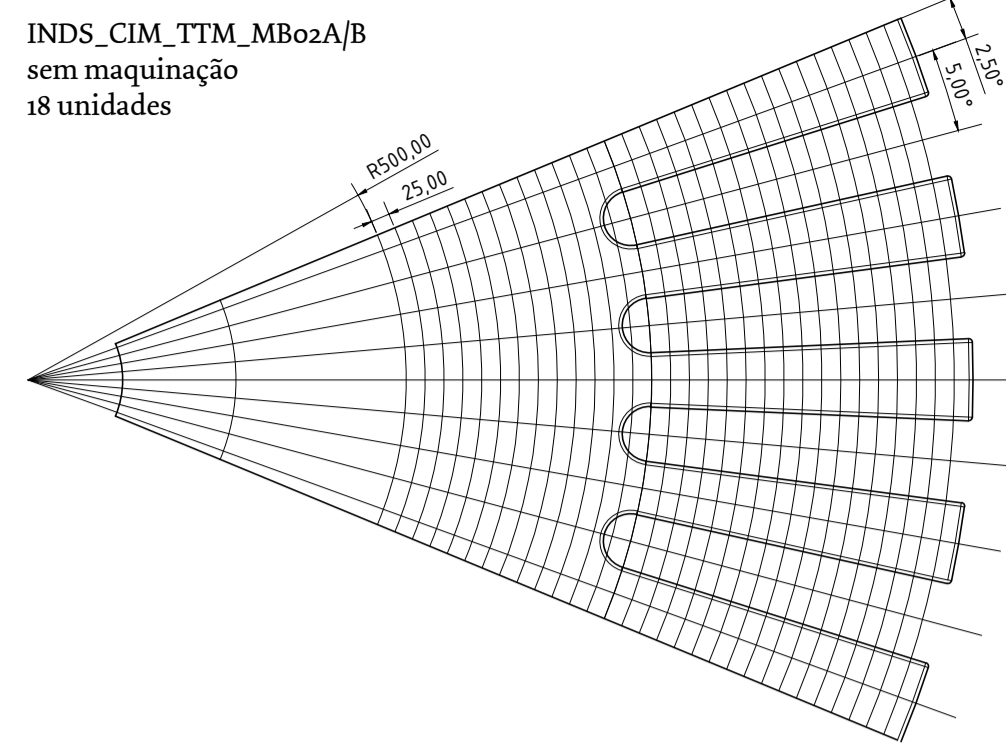

Património Mundial • World Heritage

Textos
rebaixar 4 mm

Logótipo
rebaixar conforme
escala de tons

TERRAS DE **TTM**
TRÁS-OS-MONTES
O destino natural

- 4 mm
- 3 mm
- 2 mm
- 1 mm



Ícons
rebaixar 4 mm

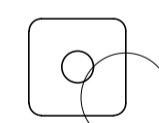

Caixa para inserir
componente
INDS_CIM_TTM_Po1
rebaixar 4 mm
furo passante Ø8,4mm

Perfurações

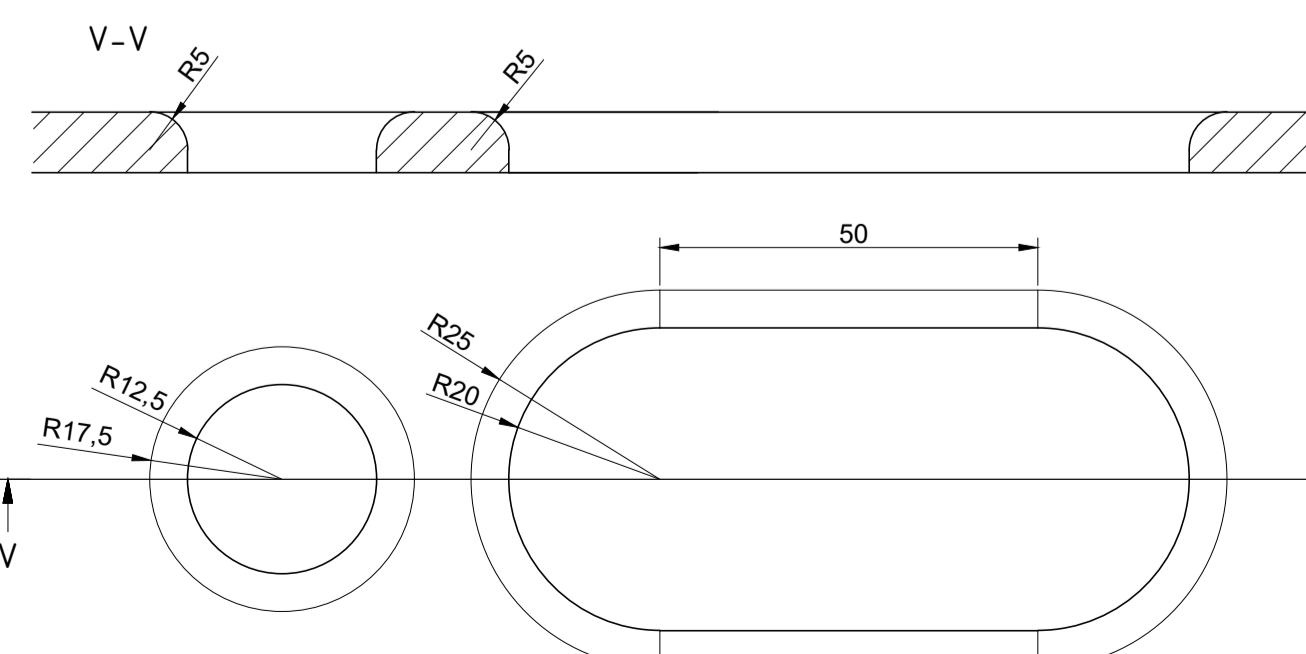

QUANT.	DESIGNAÇÃO	Nº BORNA Nº DO DESENHO	MATERIAL	Nº REF.	PRODUTO SEMI ACABADO Nº DE MOLDA/MATRIZ	PESO	OBSERVAÇÃO
18	INDS_CIM_TTM_MBo2		Alumínio Fundição arca		produzido fora - partes desmontáveis produzido em casa A&L parte		Maquinação CNC
54	INDS_CIM_TTM_MBo1		Alumínio Fundição arca		produzido fora - partes desmontáveis produzido em casa A&L parte		Maquinação CNC

PRM CIM_TTM_02 ESC 1:10

DATA 04.10.23

DES Carlos Pereira

INOISE

Morada
Avenida Ferreira 114, 6º
4760-105 V.N.Famalicão
Portugal
Site: info@inoise.com
info@inoise.com
+351 913 040 408

Textos e ícones
rebaixar 4 mm

5.543,6 Km²

9 concelhos · 9 counties

Altitude Mínima e Máxima · *Minimum and Maximum Altitude* · 123m · 1489 m

Parques e Áreas Naturais · *Parks and Natural Areas*

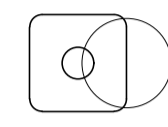

Caixa para inserir
componente
INDS_CIM_TTM_Poi
rebaixar 4 mm
furo passante Ø8,4mm

Património Mundial · *World Heritage*

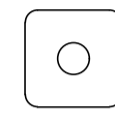

Passeios de Barco · *Boat Trips*

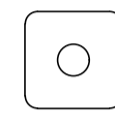

Passeios turísticos · *Sightseeing*

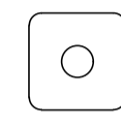
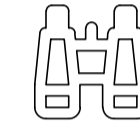

Praias Fluviais · *River Beaches*

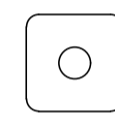

Passeios Pedestres · *Walking Tours*

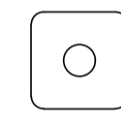

Miradouros · *Viewpoints*

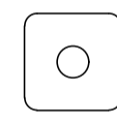

Eventos · *Events*

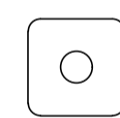
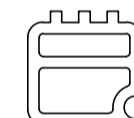

Gastronomia · *Gastronomy*

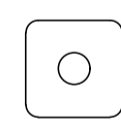

Museus · *Museums*

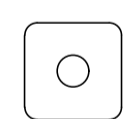

Parques Temáticos · *Thematic Parks*

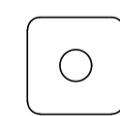

Aldeias típicas · *Typical Villages*

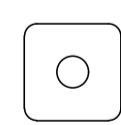

Castelos · *Castles*

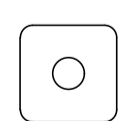
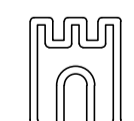

Centros Históricos · *Historic Centers*

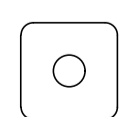
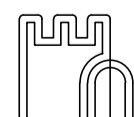

Alojamento · *Accommodation*

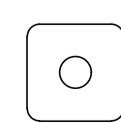
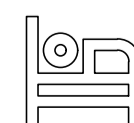

INDS_CIM_TTM_MB01
Maquinação 4
9 unidades

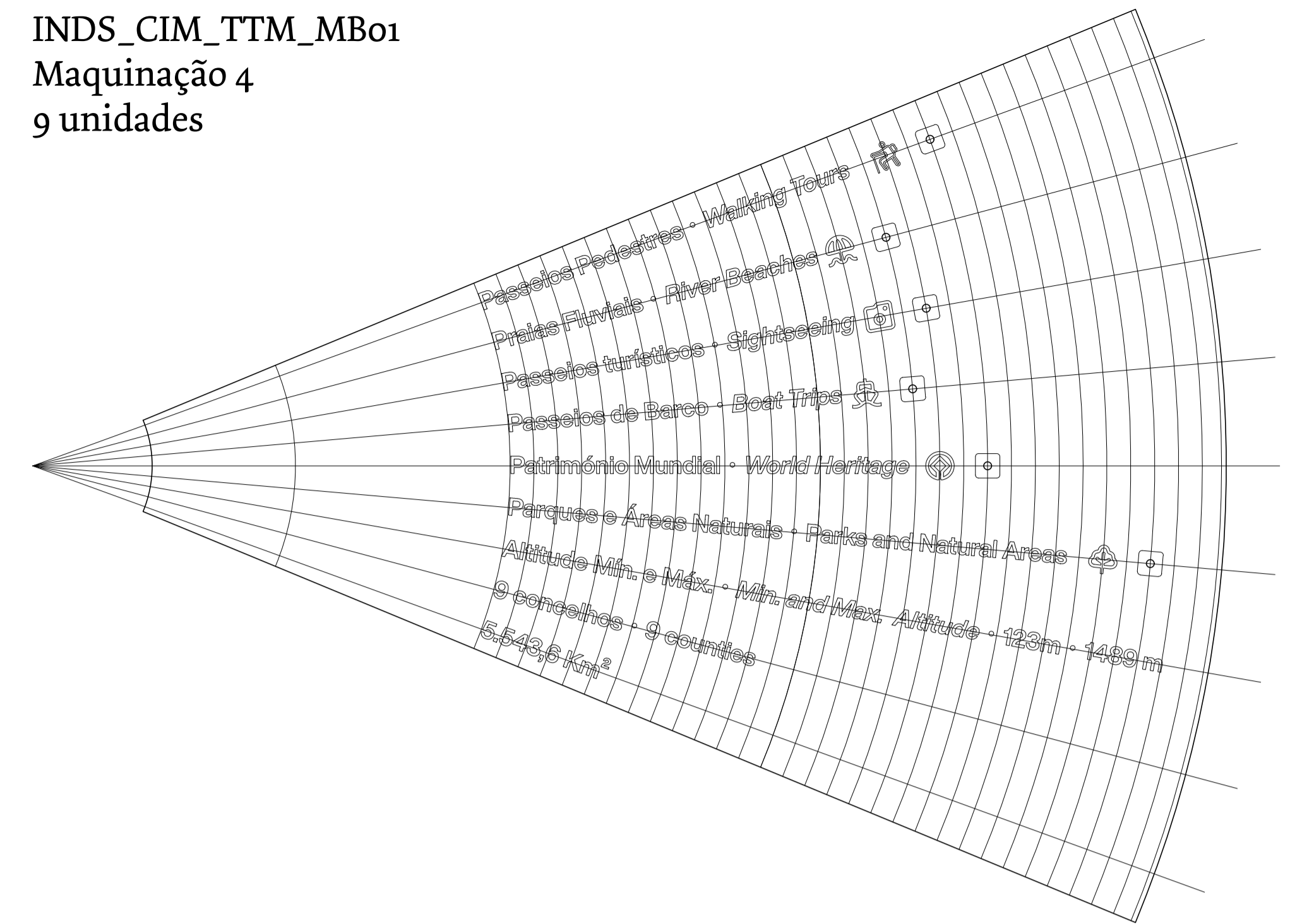

INDS_CIM_TTM_MB01
Maquinação 5
9 unidades

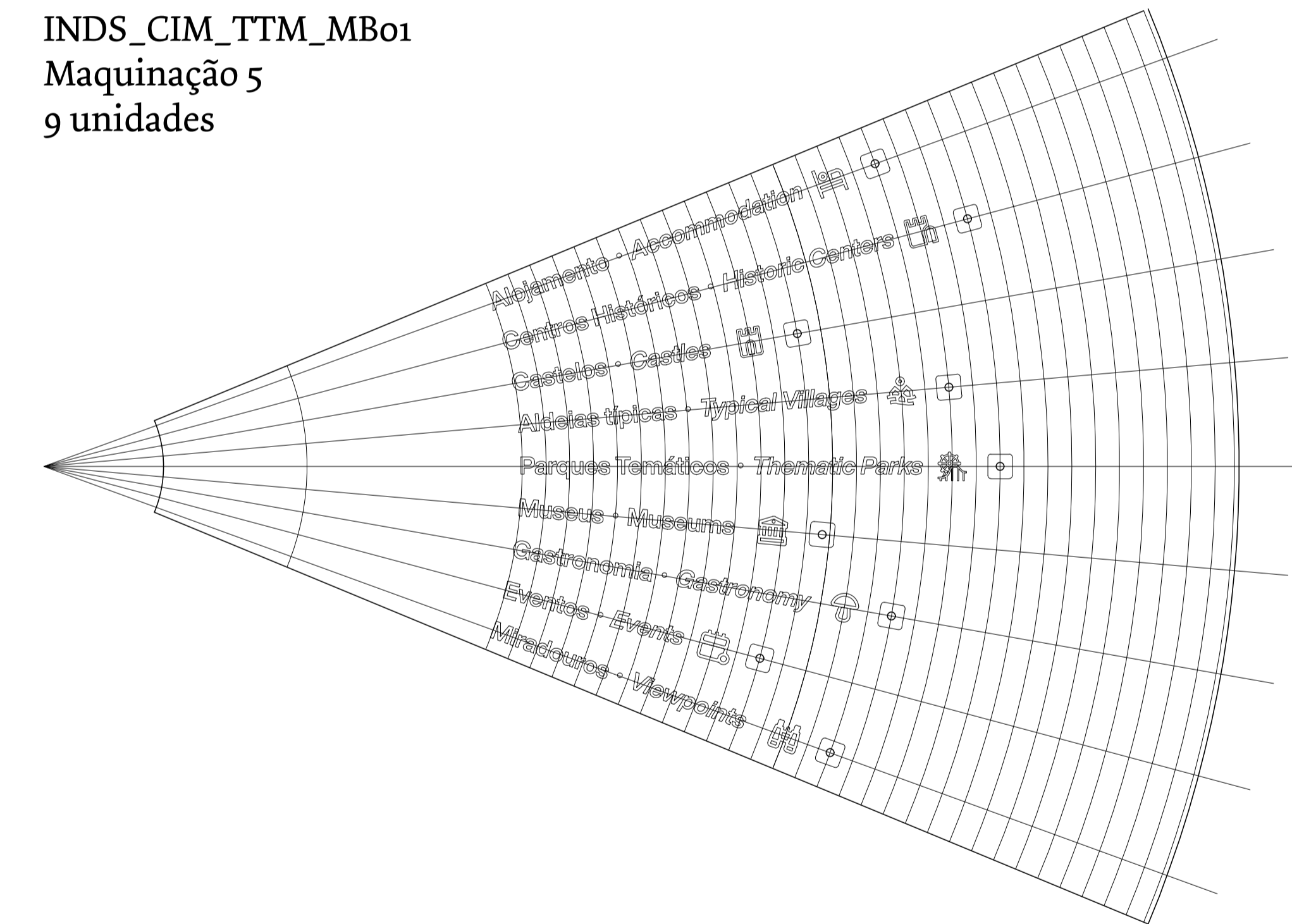

PRM	CIM_TTM_03	ESC	112
DATA	04.10.23	TEC	Carlos Pereira
DES			

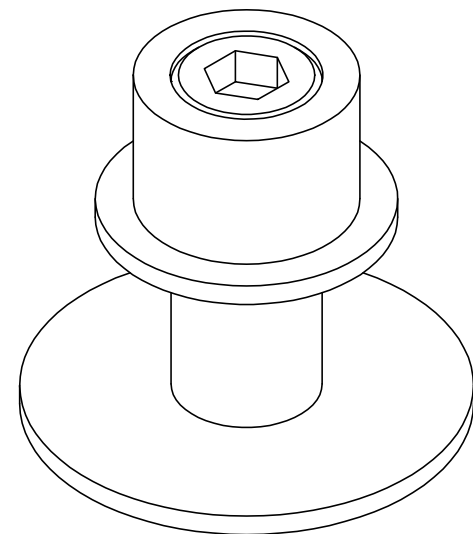
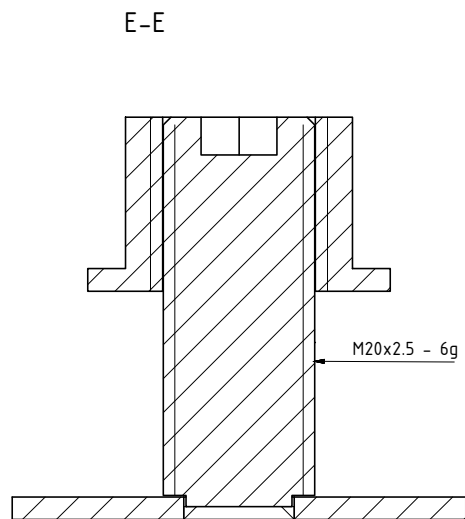
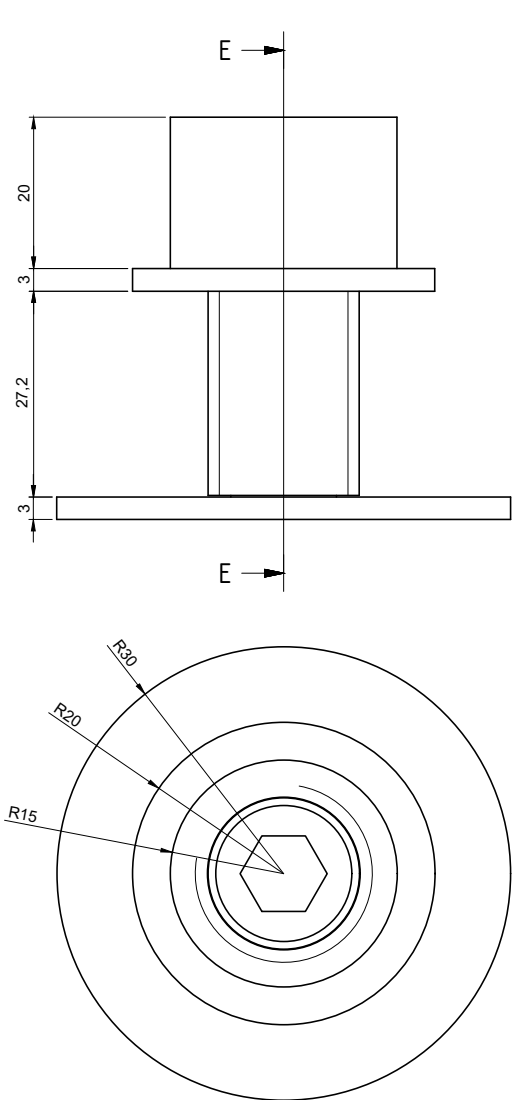
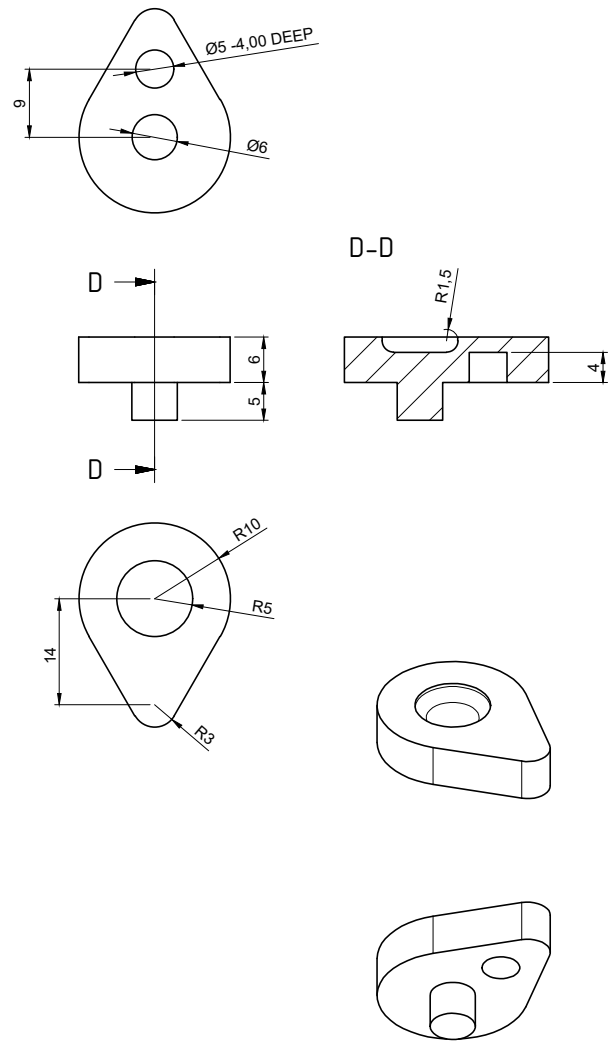
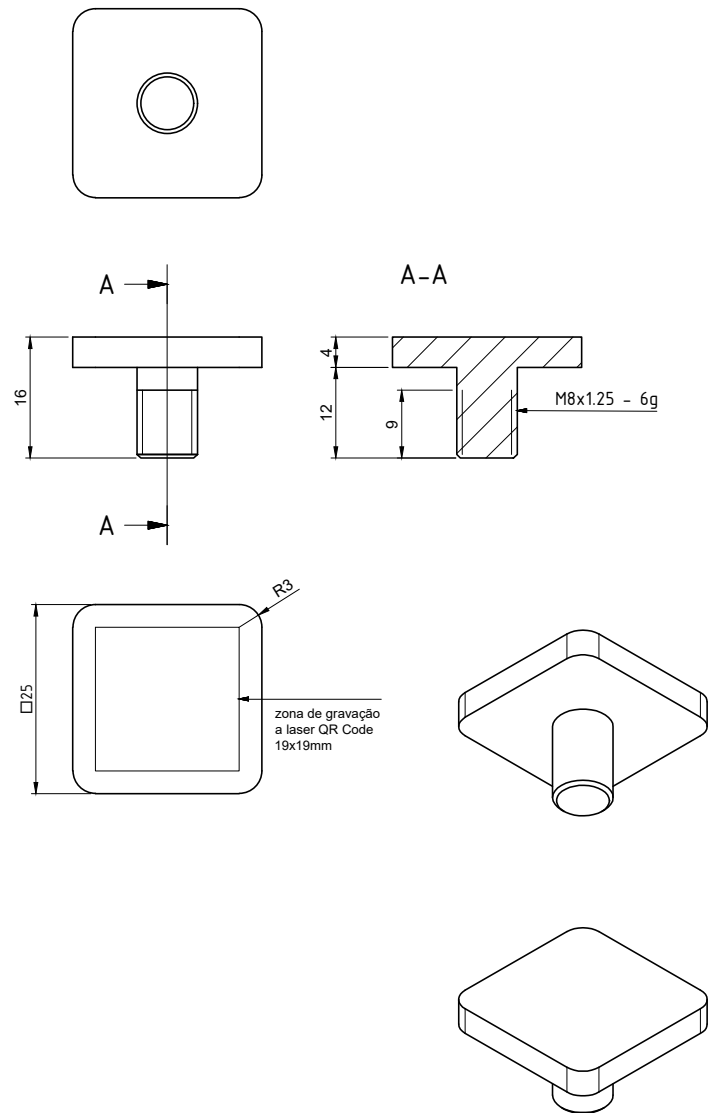

QUANT.	DESIGNAÇÃO	Nº NORMA Nº DO DESENHO	MATERIAL	Nº REE.	PRODUTO SEMI ACABADO Nº DE MOLDE/MATRIZ	PESO	OBSERVAÇÃO
54	INDS_CIM_TTM_Po3		Porca de cravar, Perno M20 e Chapa de aço 3mm		Pintura RAL 9005		
15	INDS_CIM_TTM_Po2		Aço inoxidável 316L		Pintura RAL 3026		Impressão 3D - Laser Melting Metal
150	INDS_CIM_TTM_Po1		Latão		Pintura RAL 9010		Gravação QR Code a laser

PROJ. CIM_TTM_o4

ESC. 1:1

DATA 04.10.23

TÉC. Carlos Pereira

OBS.

INDUSE

Morada
Av.Narciso Ferreira nº41, 6º
4760-105 V.N.Famalicão
Portugal

Site|Email
www.induse.com
info@induse.com

+351 913 040 408

INDS_CIM_TTM_C01

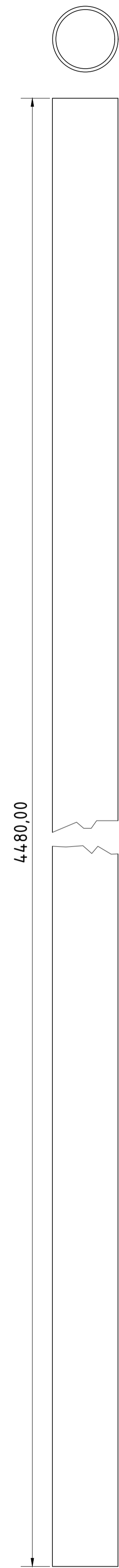

INDS_CIM_TTM_C02

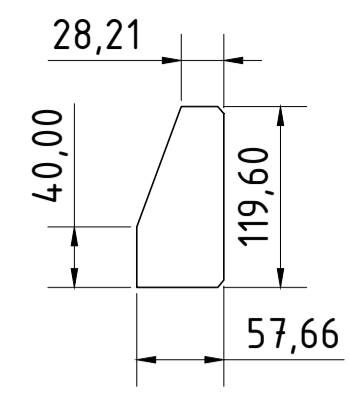

INDS_CIM_TTM_CE

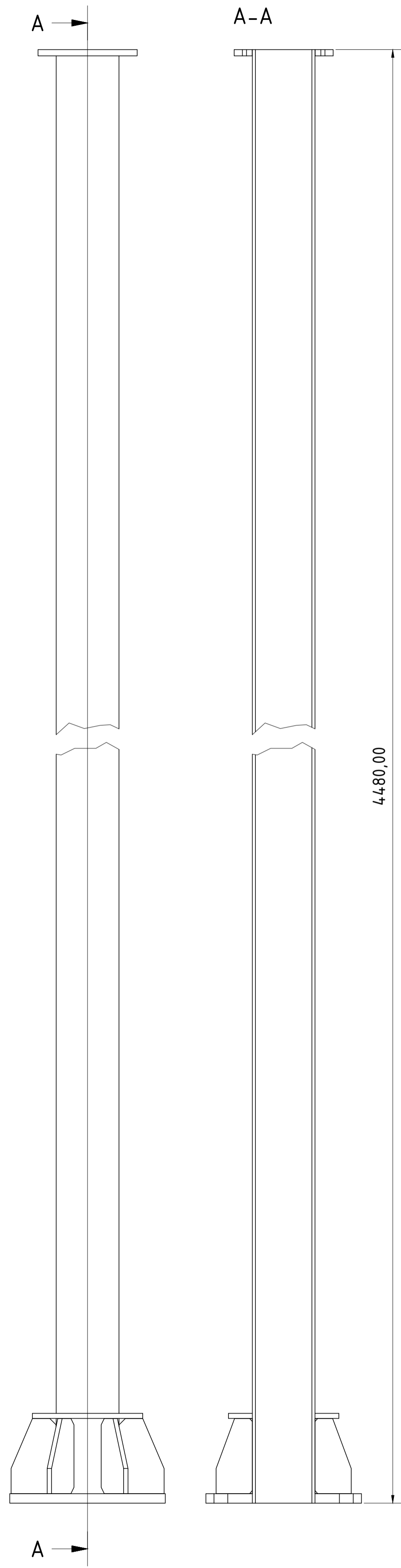

INDS_CIM_TTM_C03

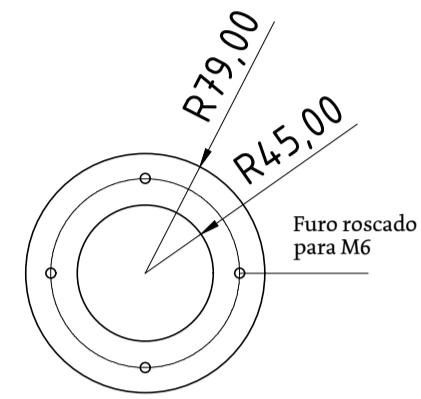

INDS_CIM_TTM_C04

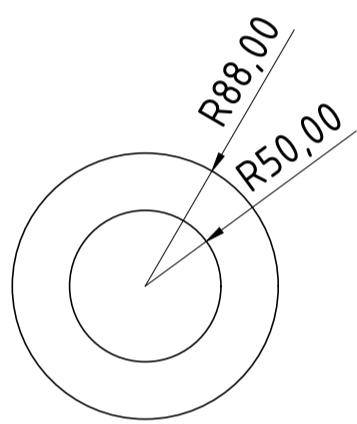

INDS_CIM_TTM_C05

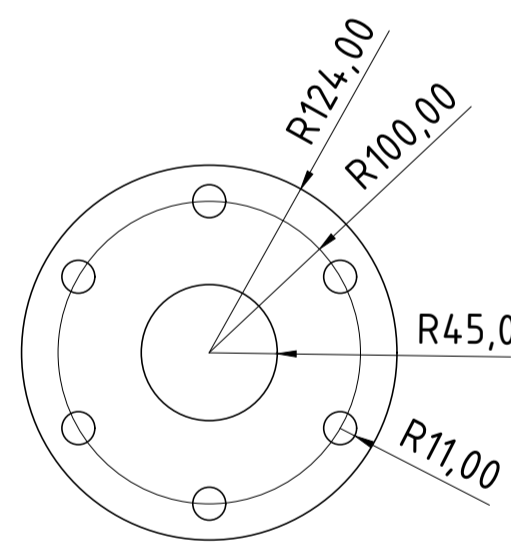

INDS_CIM_TTM_C06

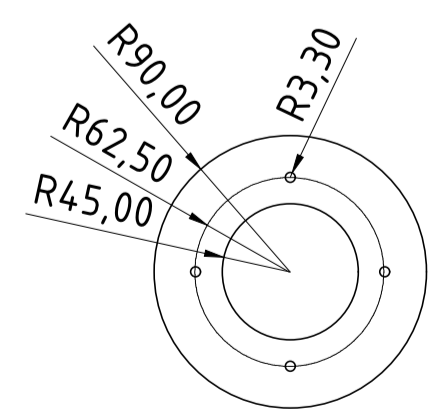

INDS_CIM_TTM_C06

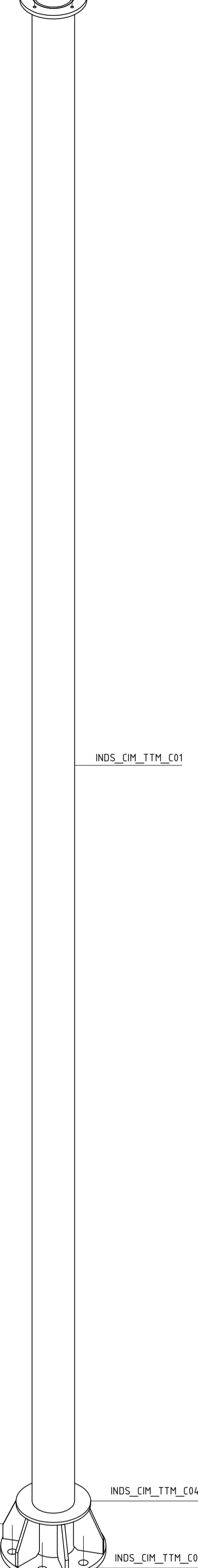
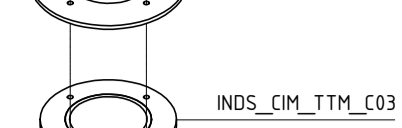

INDS_CIM_TTM_BASE

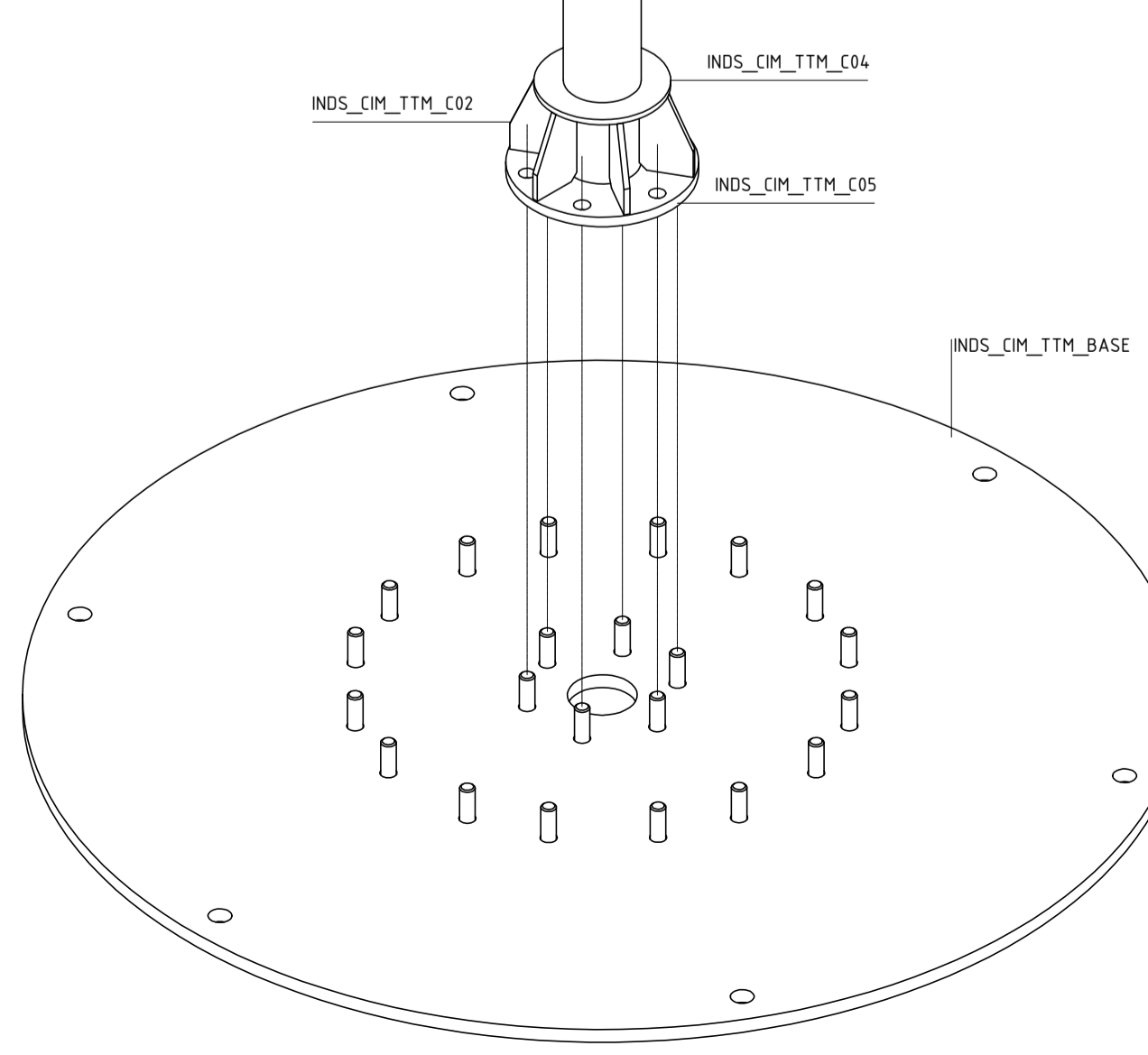
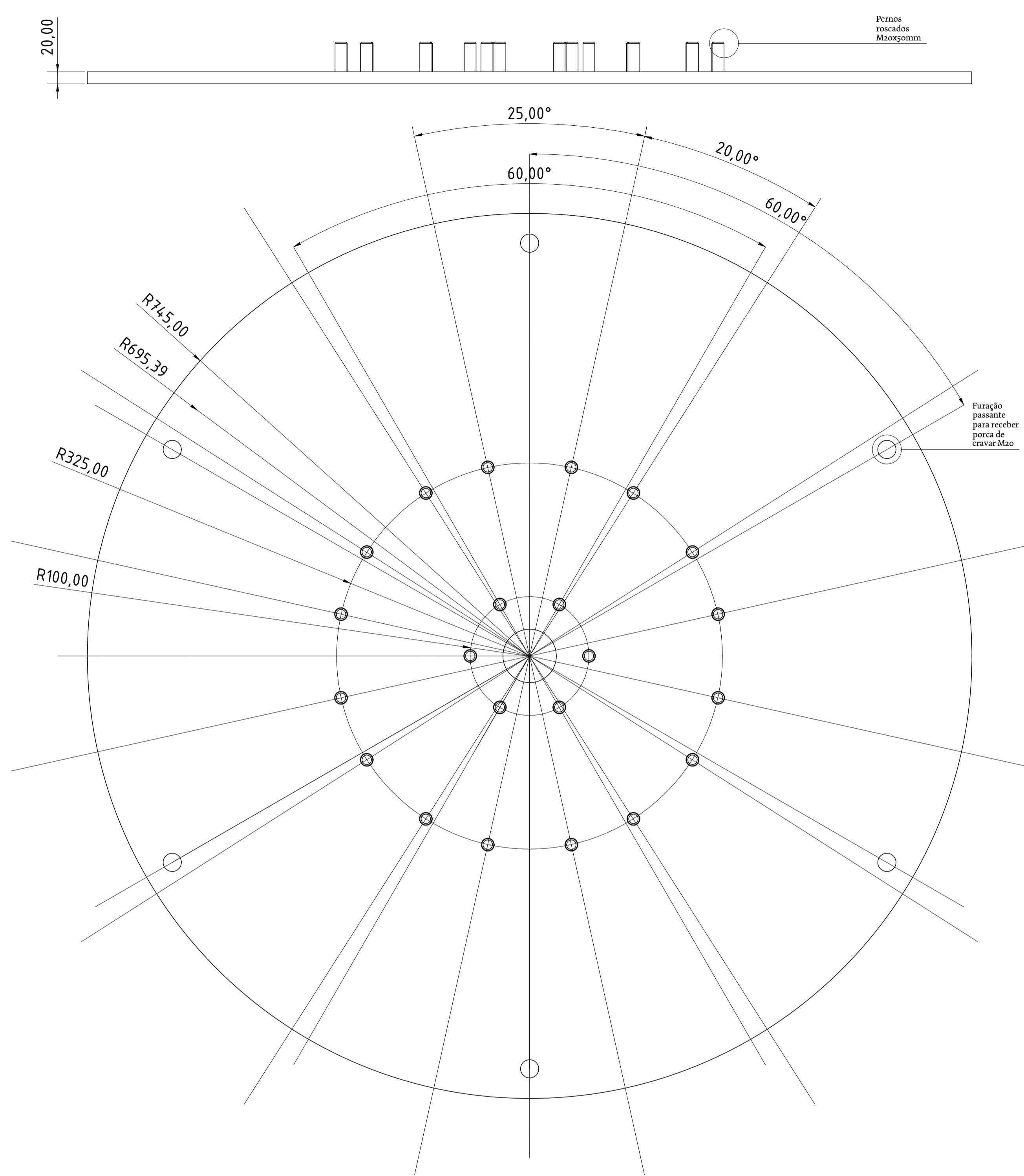

QUANT.	DESIGNAÇÃO	Nº MODAL Nº DO DESENHO	MATERIAL	Nº REF.	PRODUTO SEM ACABADO Nº DE INSCRIÇÃO	PESO	OBSERVAÇÃO
9	INDS_CIM_TTM_BASE		Chapa de aço 10 mm Pernos roscados M6		pintura electrostática a pó de primário + tinta RAL 9005		Soldadura de todos os componentes
9	INDS_CIM_TTM_CE		Chapa de aço 10 mm		pintura electrostática a pó de primário + tinta RAL 9005		Soldadura de todos os componentes
18	INDS_CIM_TTM_C06		Chapa de aço 3mm		pintura electrostática a pó de primário + tinta RAL 9005		
18	INDS_CIM_TTM_C05		Chapa de aço 15mm		pintura electrostática a pó de primário + tinta RAL 9005		
18	INDS_CIM_TTM_C04		Chapa de aço 10mm				
18	INDS_CIM_TTM_C03		Chapa de aço 8mm				
18	INDS_CIM_TTM_C02		Chapa de aço 8mm				
54	INDS_CIM_TTM_C01		Tubo de aço estrutural D100x5mm Norma 10219-1/2				

PRAL CIM_TTM_05 ESC 1:10
 DATA 04.10.23
 DES Carlos Pereira

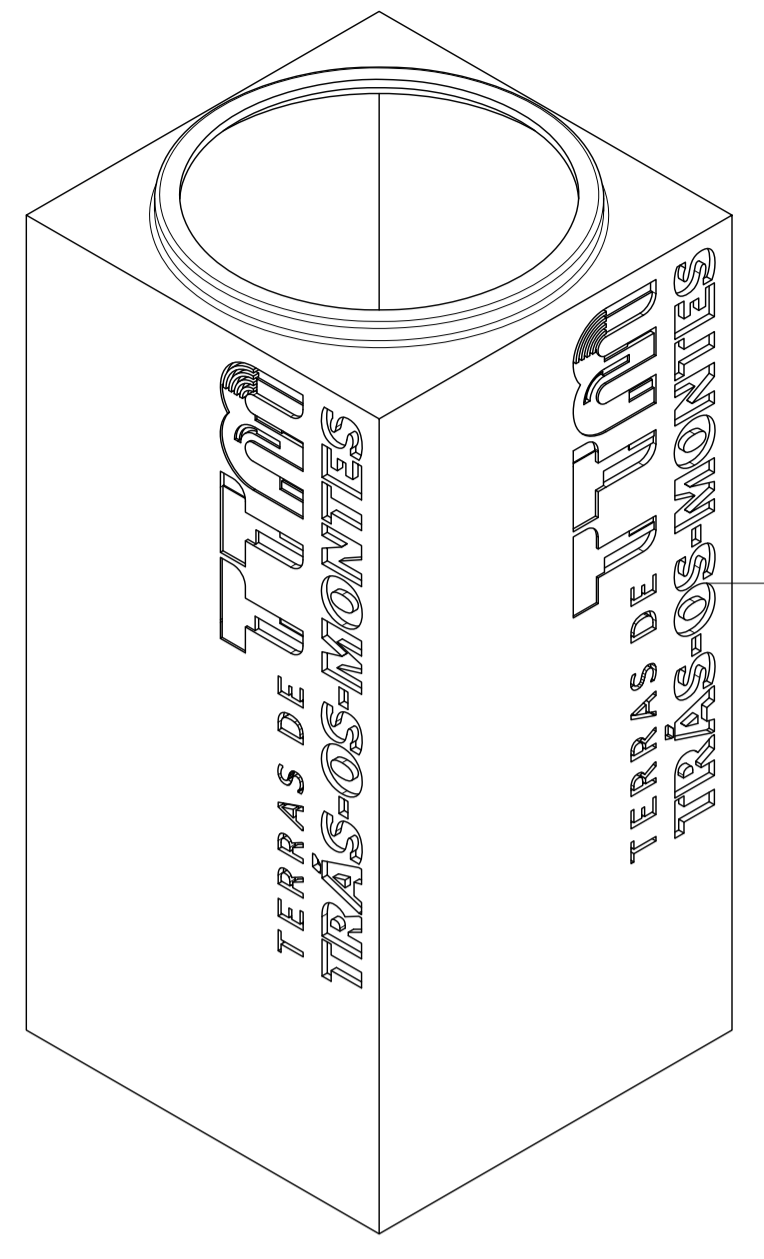
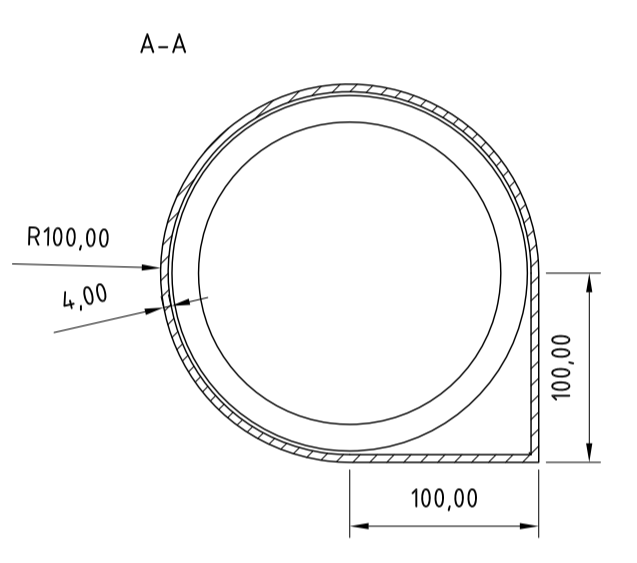
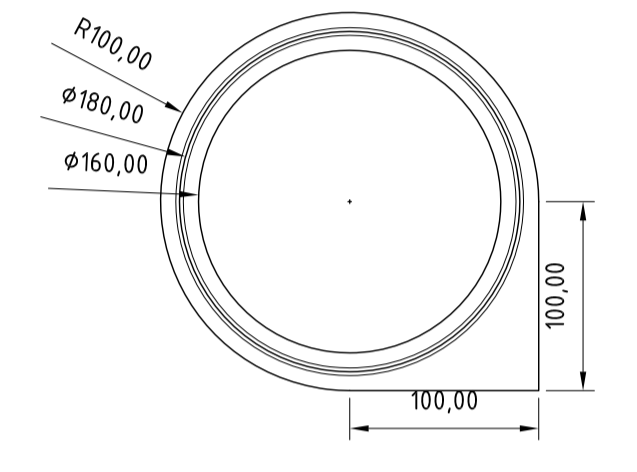
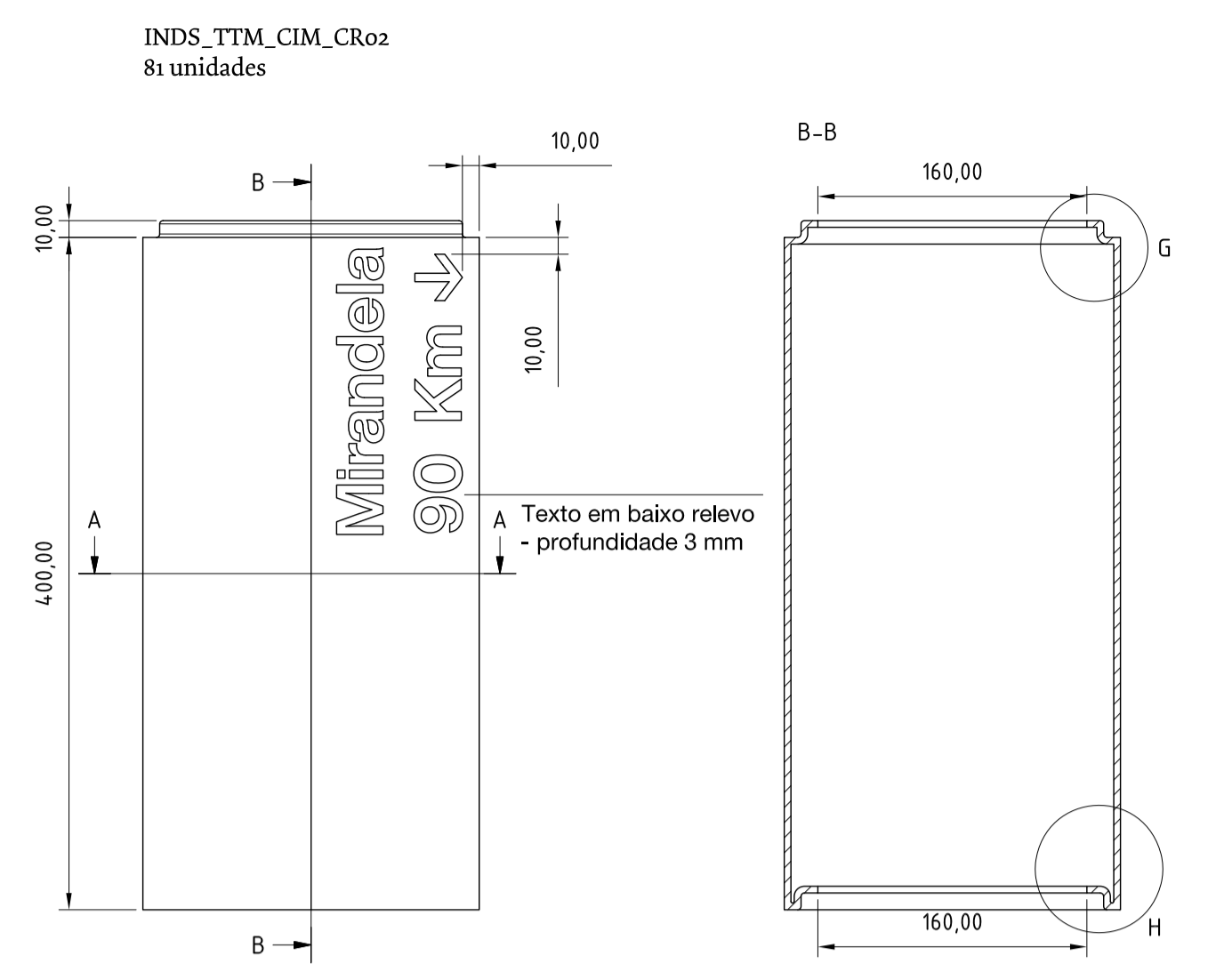
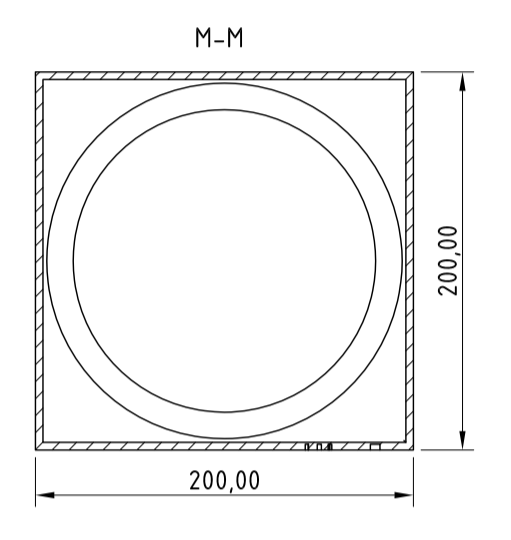
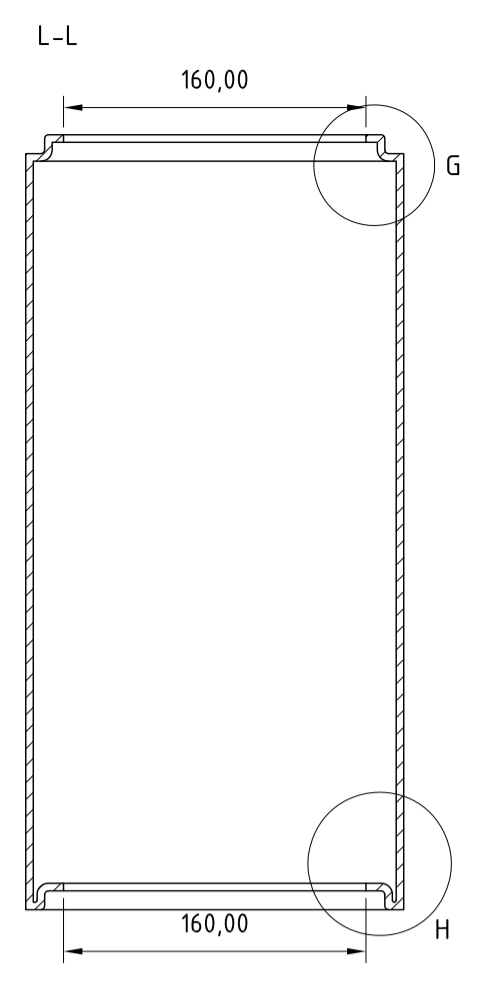
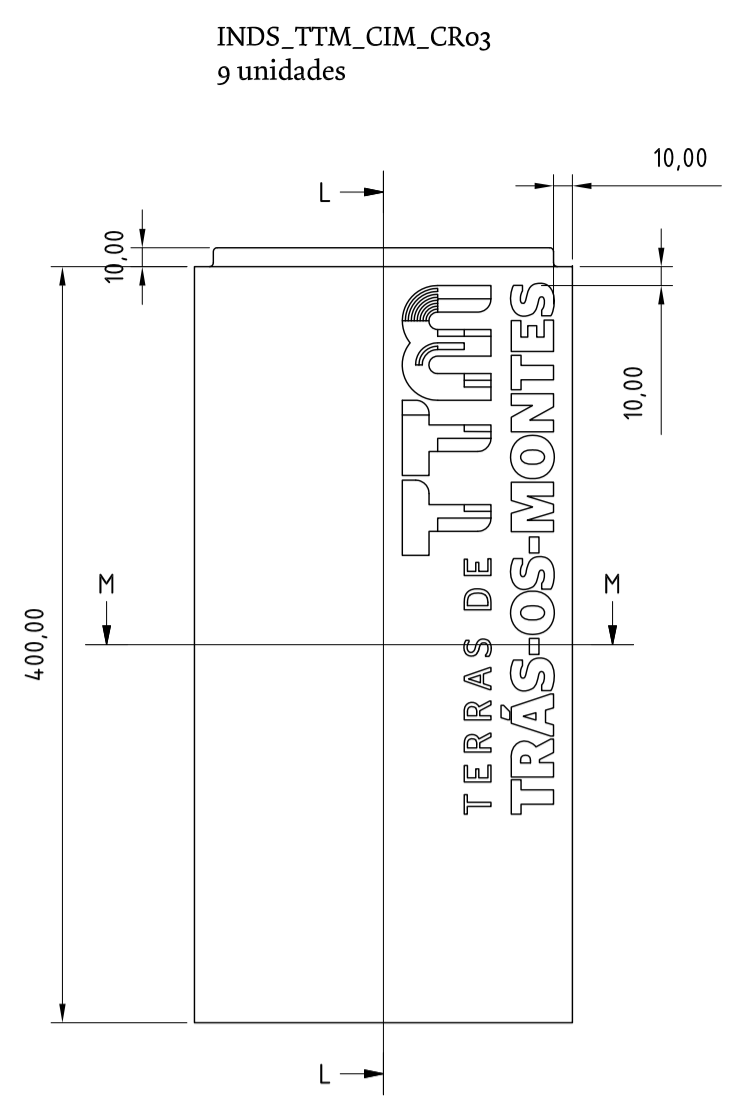

Maquinação do Logótipo nas 4 faces do componente em baixo relevo

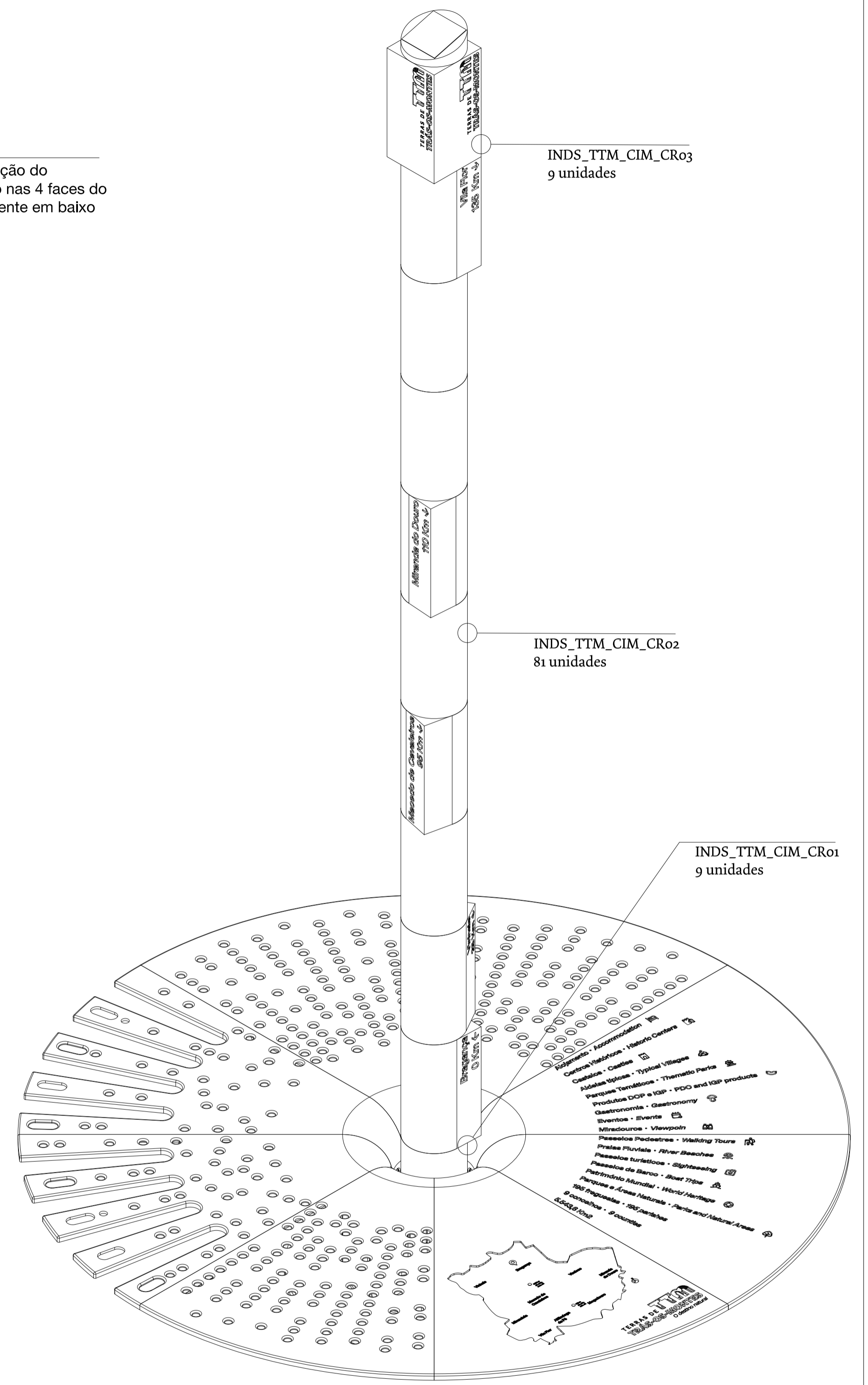
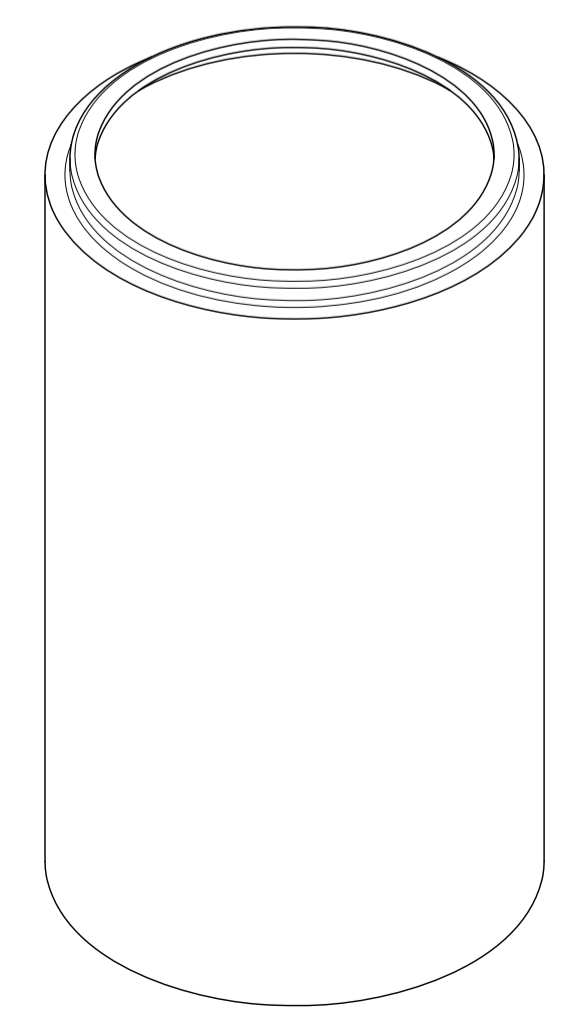
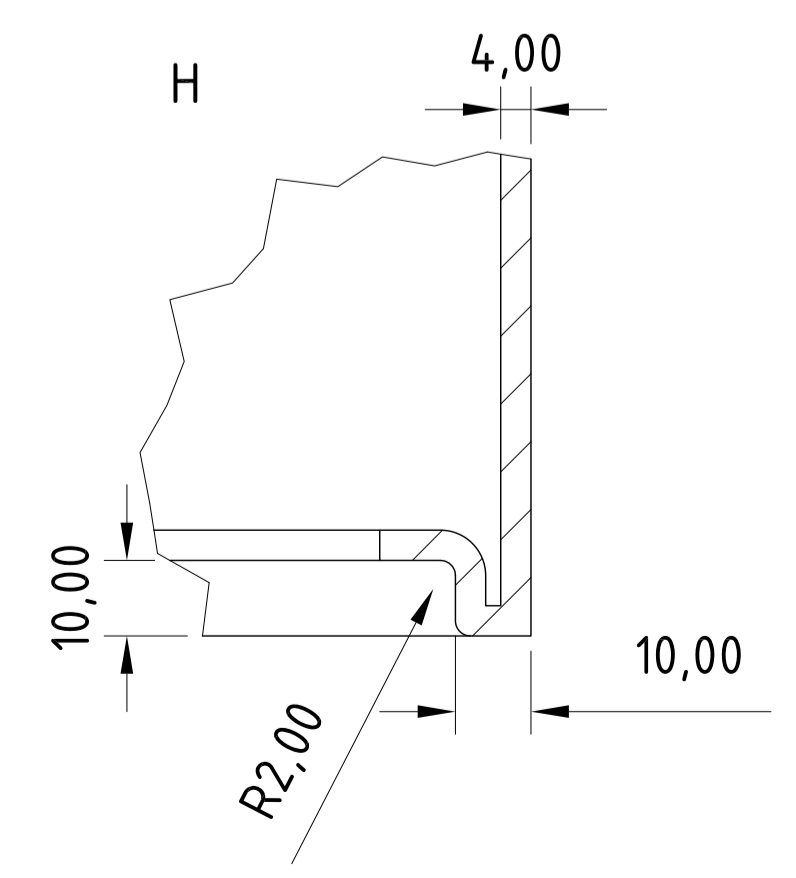
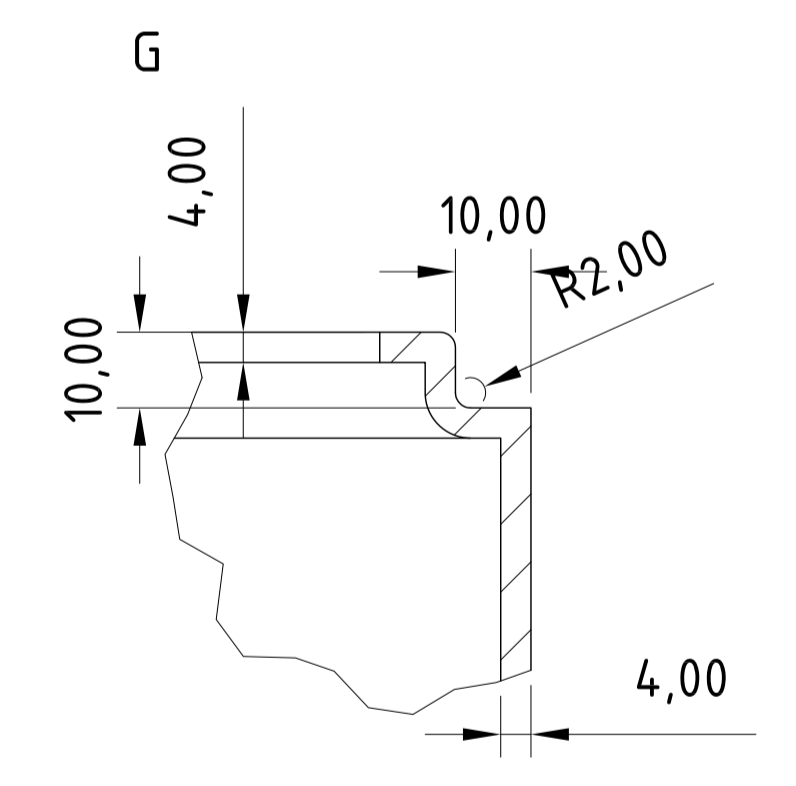
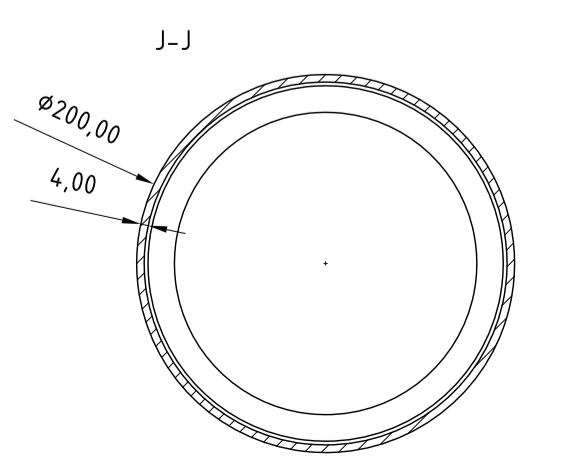
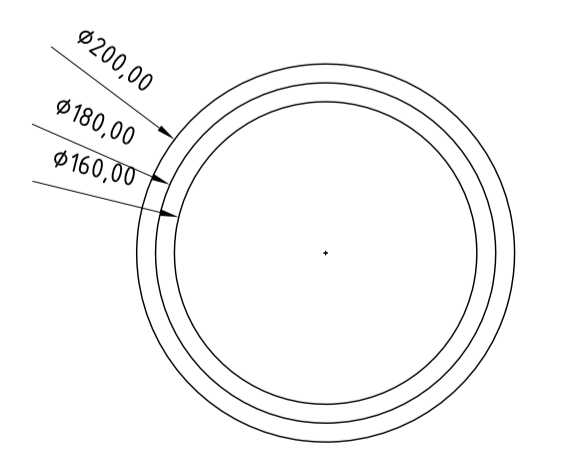
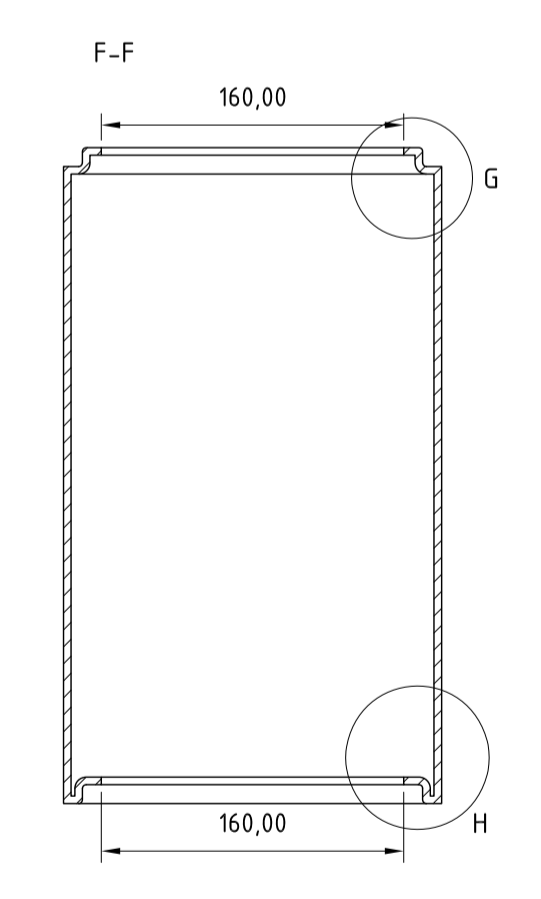
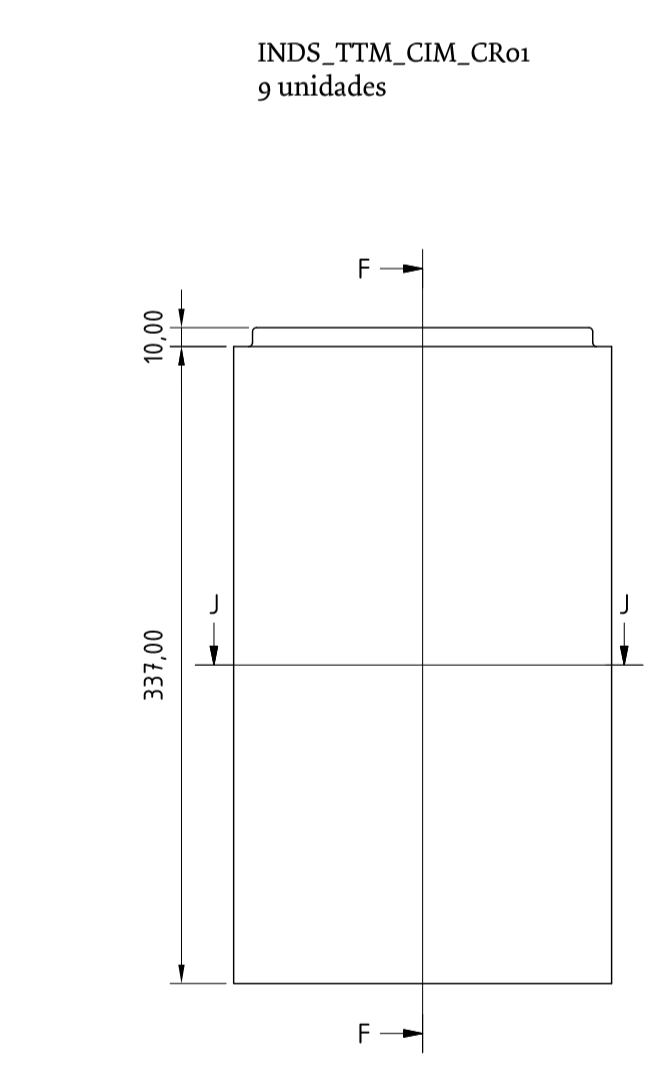
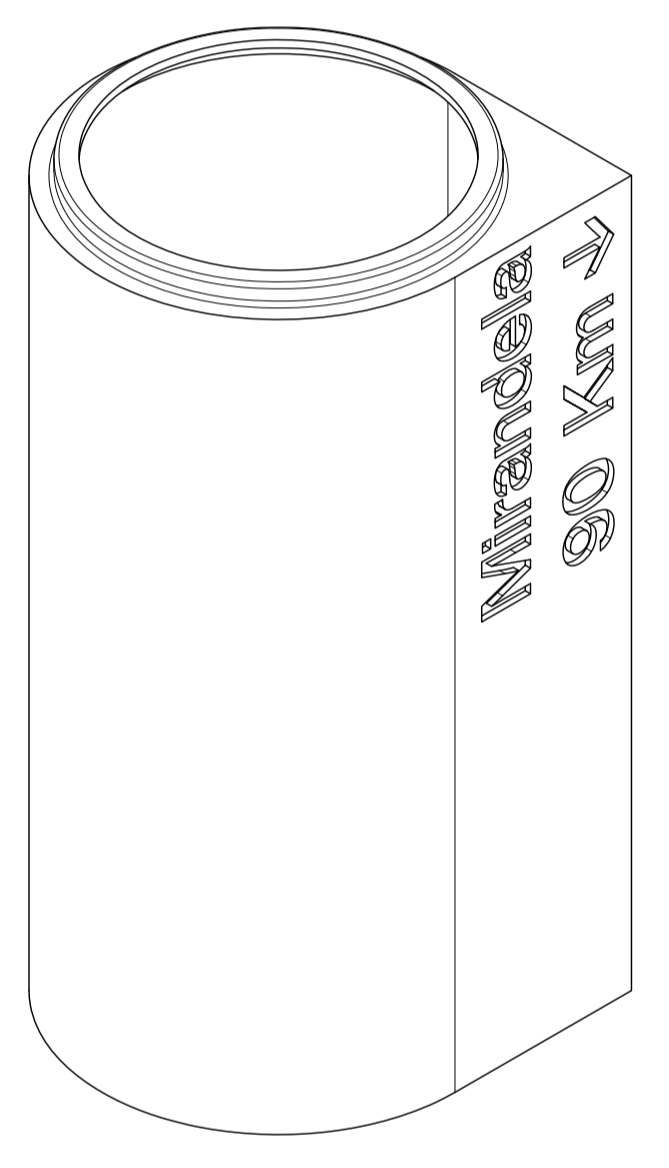

QUAN.	DESIGNAÇÃO	Nº NORMA Nº DO DESENHO	MATERIAL	Nº REF.	PRODUTO SEMI ACABADO Nº DE MOLDES/UNI PRZ	PESO	OBSERVAÇÃO
9	INDS_TTM_CIM_CR03		Polimero Reforçado com Fibra de Vidro				Maquinação CNC
81	INDS_TTM_CIM_CR02		Polimero Reforçado com Fibra de Vidro				Maquinação CNC
9	INDS_TTM_CIM_CR01		Polimero Reforçado com Fibra de Vidro				Maquinação CNC

PRZ: CIM_TTM_06
 DATA: 04.10.23
 OBS: Carlos Pereira

Área correspondente ao plano de inserção
400x100mm - margens 10mm

Bragança 34 Km ↓	Vinhais 34 Km ↓	Vimioso 45 Km ↓	Miranda do Douro 74 Km ↓	Mogadouro 77 Km ↓
Bragança 45 Km ↓	Vinhais 78 Km ↓	Vimioso 78 Km ↓	Miranda do Douro 108 Km ↓	Mogadouro 97 Km ↓
Bragança 74 Km ↓	Vinhais 108 Km ↓	Vimioso 29 Km ↓	Miranda do Douro 29 Km ↓	Mogadouro 36 Km ↓
Bragança 77 Km ↓	Vinhais 97 Km ↓	Vimioso 36 Km ↓	Miranda do Douro 47 Km ↓	Mogadouro 47 Km ↓
Bragança 76 Km ↓	Vinhais 79 Km ↓	Vimioso 73 Km ↓	Miranda do Douro 81 Km ↓	Mogadouro 38 Km ↓
Bragança 45 Km ↓	Vinhais 48 Km ↓	Vimioso 55 Km ↓	Miranda do Douro 83 Km ↓	Mogadouro 46 Km ↓
Bragança 85 Km ↓	Vinhais 88 Km ↓	Vimioso 95 Km ↓	Miranda do Douro 103 Km ↓	Mogadouro 59 Km ↓
Bragança 65 Km ↓	Vinhais 59 Km ↓	Vimioso 80 Km ↓	Miranda do Douro 120 Km ↓	Mogadouro 76 Km ↓
Alfândega da Fé 76 Km ↓	Macedo de Cavaleiros 45 Km ↓	Vila Flor 85 Km ↓	Mirandela 65 Km ↓	
Alfândega da Fé 79 Km ↓	Macedo de Cavaleiros 48 Km ↓	Vila Flor 88 Km ↓	Mirandela 59 Km ↓	
Alfândega da Fé 73 Km ↓	Macedo de Cavaleiros 55 Km ↓	Vila Flor 95 Km ↓	Mirandela 80 Km ↓	
Alfândega da Fé 81 Km ↓	Macedo de Cavaleiros 83 Km ↓	Vila Flor 103 Km ↓	Mirandela 120 Km ↓	
Alfândega da Fé 38 Km ↓	Macedo de Cavaleiros 46 Km ↓	Vila Flor 59 Km ↓	Mirandela 76 Km ↓	
Alfândega da Fé 32 Km ↓	Macedo de Cavaleiros 32 Km ↓	Vila Flor 25 Km ↓	Mirandela 40 Km ↓	
Alfândega da Fé 41 Km ↓	Macedo de Cavaleiros 41 Km ↓	Vila Flor 41 Km ↓	Mirandela 27 Km ↓	
Alfândega da Fé 27 Km ↓	Macedo de Cavaleiros 27 Km ↓	Vila Flor 25 Km ↓	Mirandela 25 Km ↓	
Macedo de Cavaleiros 0 Km ←	Vila Flor 0 Km ←			
Vinhais 0 Km ←	Alfândega da Fé 0 Km ←			
Mirandela 0 Km ←	Mogadouro 0 Km ←			
Bragança 0 Km ←	Miranda do Douro 0 Km ←			
Vimioso 0 Km ←				

Logótipo componente
INDS_TTM_CIM_CRo2
9 unidades

O Logótipo
será maquinado nas
quatro faces do
componente

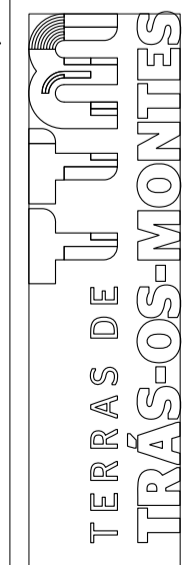

Logótipo
rebaixar conforme
escala de tons



- 3 mm
- 2 mm
- 1.5 mm
- 1 mm

QUANT.	DESIGNAÇÃO	Nº NORMA Nº DO DESENHO	MATERIAL	Nº REF.	PRODUTO SEMI ACABADO Nº DE MOLDE/UNI PRZ	PESO	OBSERVAÇÃO
9	INDS_TTM_CIM_CRo1		Polímero Reforçado com Fibra de Vidro				Maquinção CNC
81	INDS_TTM_CIM_CRo2		Polímero Reforçado com Fibra de Vidro				Maquinção CNC
9	INDS_TTM_CIM_CRo3		Polímero Reforçado com Fibra de Vidro				Maquinção CNC

PRZ: CIM_TTM_o6A Designações

DATA: 04.10.23

ESC: 1:4
1:2

ITC: Carlos Pereira



Morada
43-30000 Ferreria 0141_01
4350-105 V.N. Famalicão
Portugal
SiteEmail
www.indiase.com
info@indiase.com
+351 913 040 408

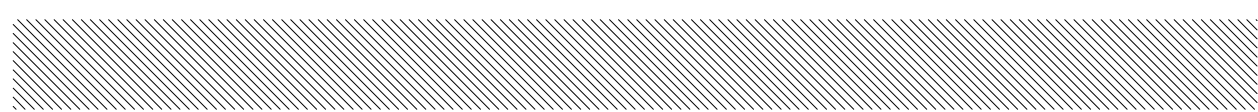
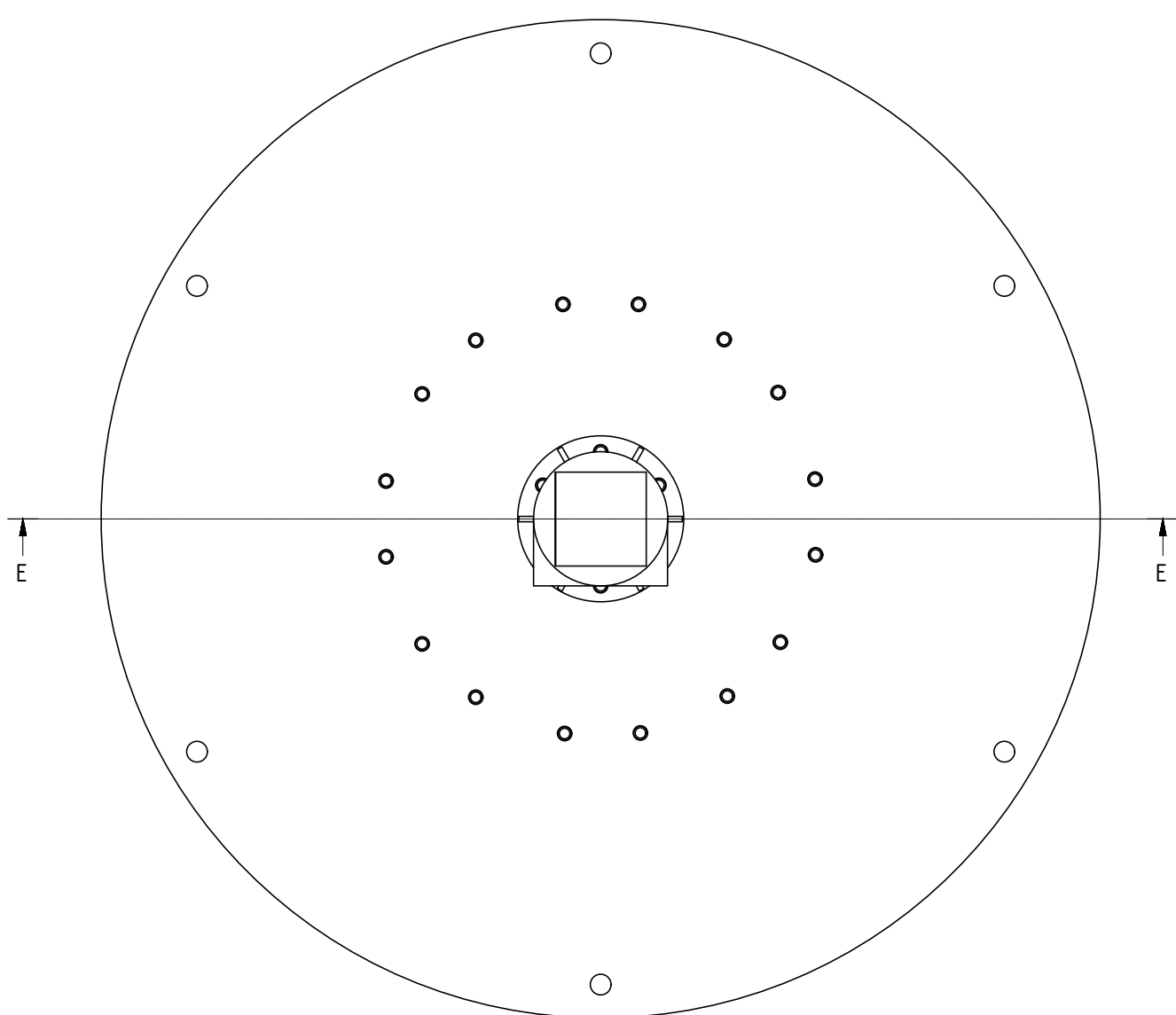
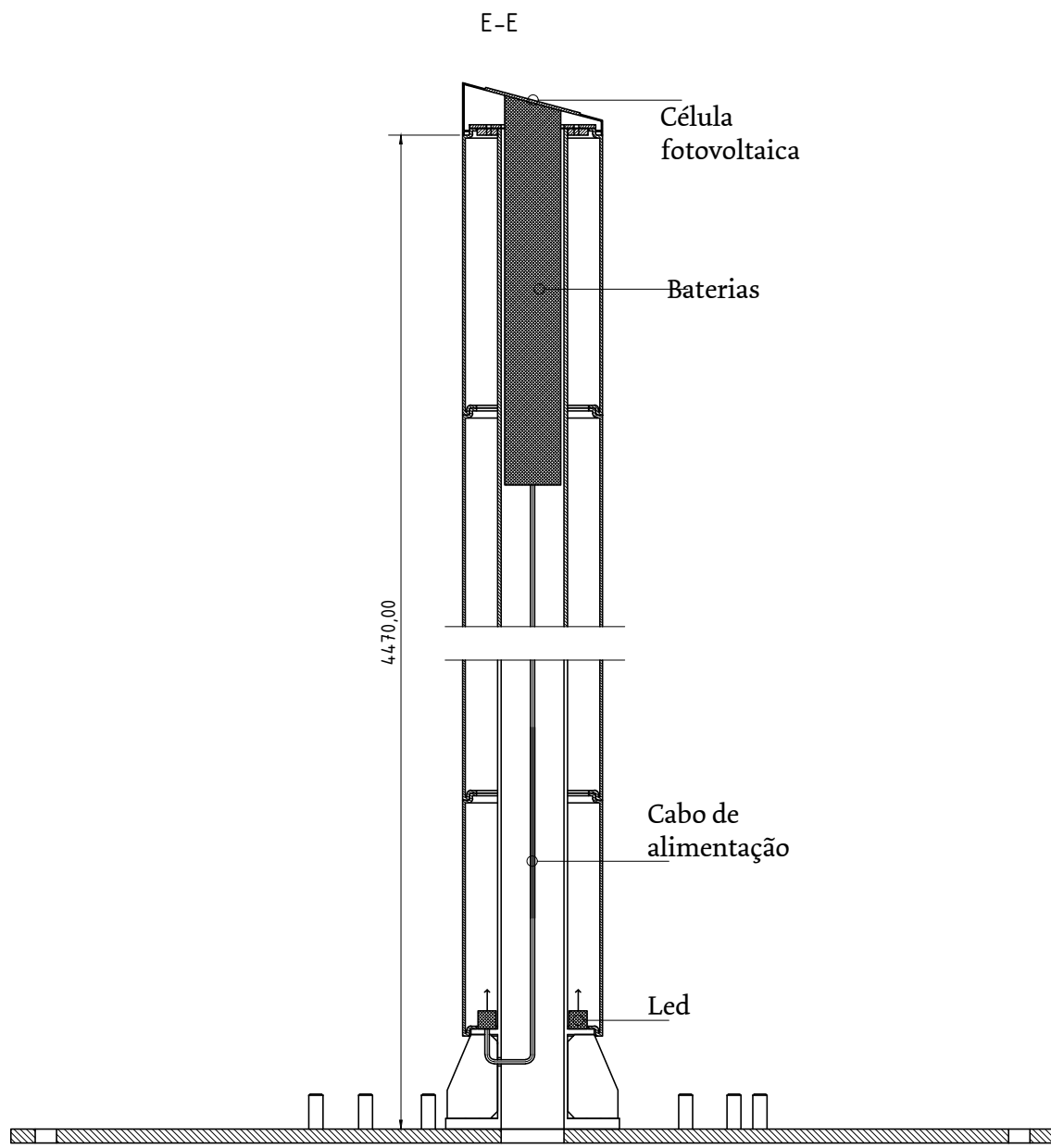

PROJ.	CIM_TTM_07	ESC.	1:1
DATA	04.10.23	TÉC.	Carlos Pereira
OBS.	Esquema para sistema de iluminação		

INDUSE

Morada
 Av.Narciso Ferreira nº41, 6º
 4760-105 V.N.Famalicão
 Portugal

Site|Email
 www.induse.com
 info@induse.com

+351 913 040 408

4.565,00

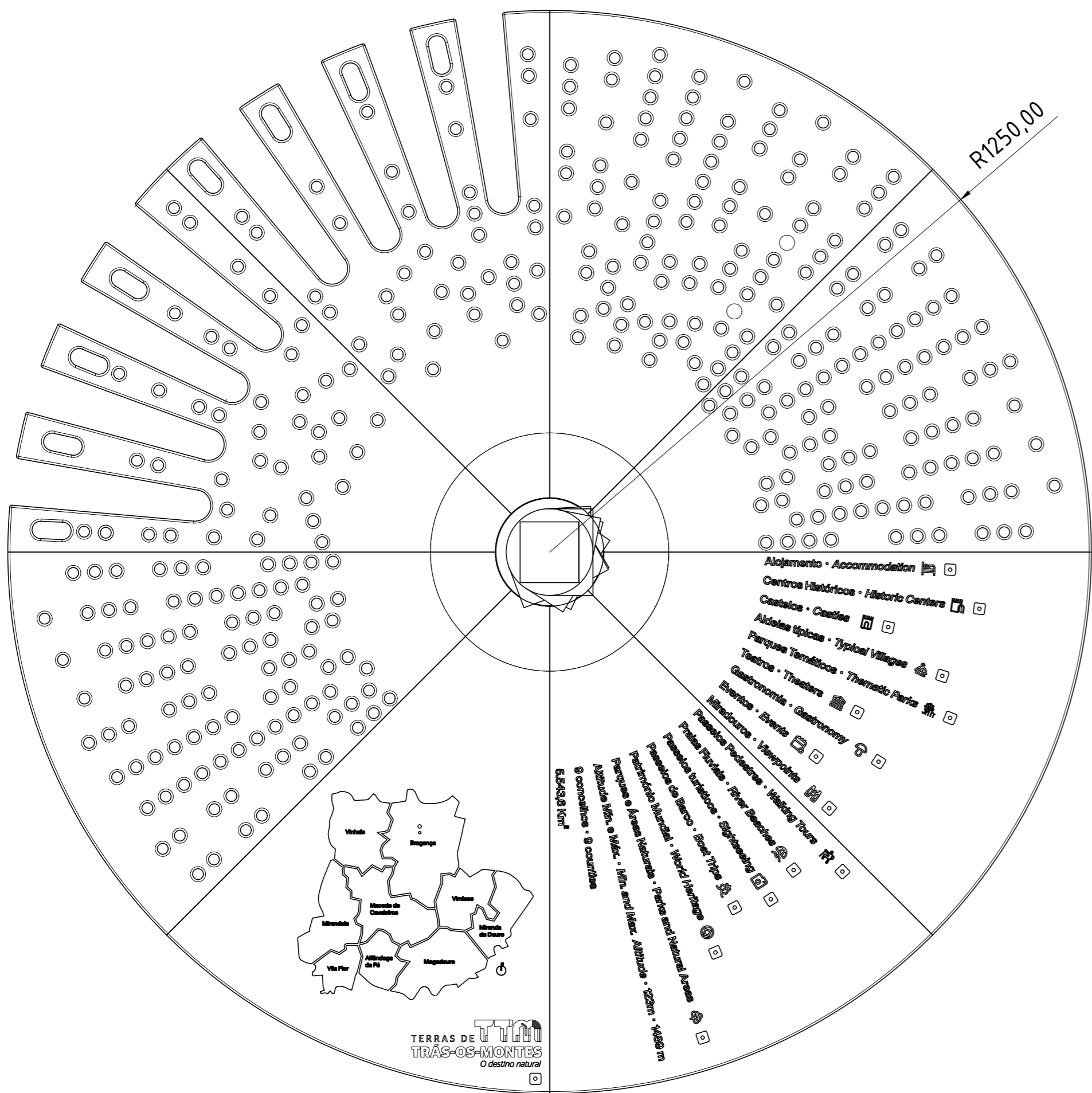
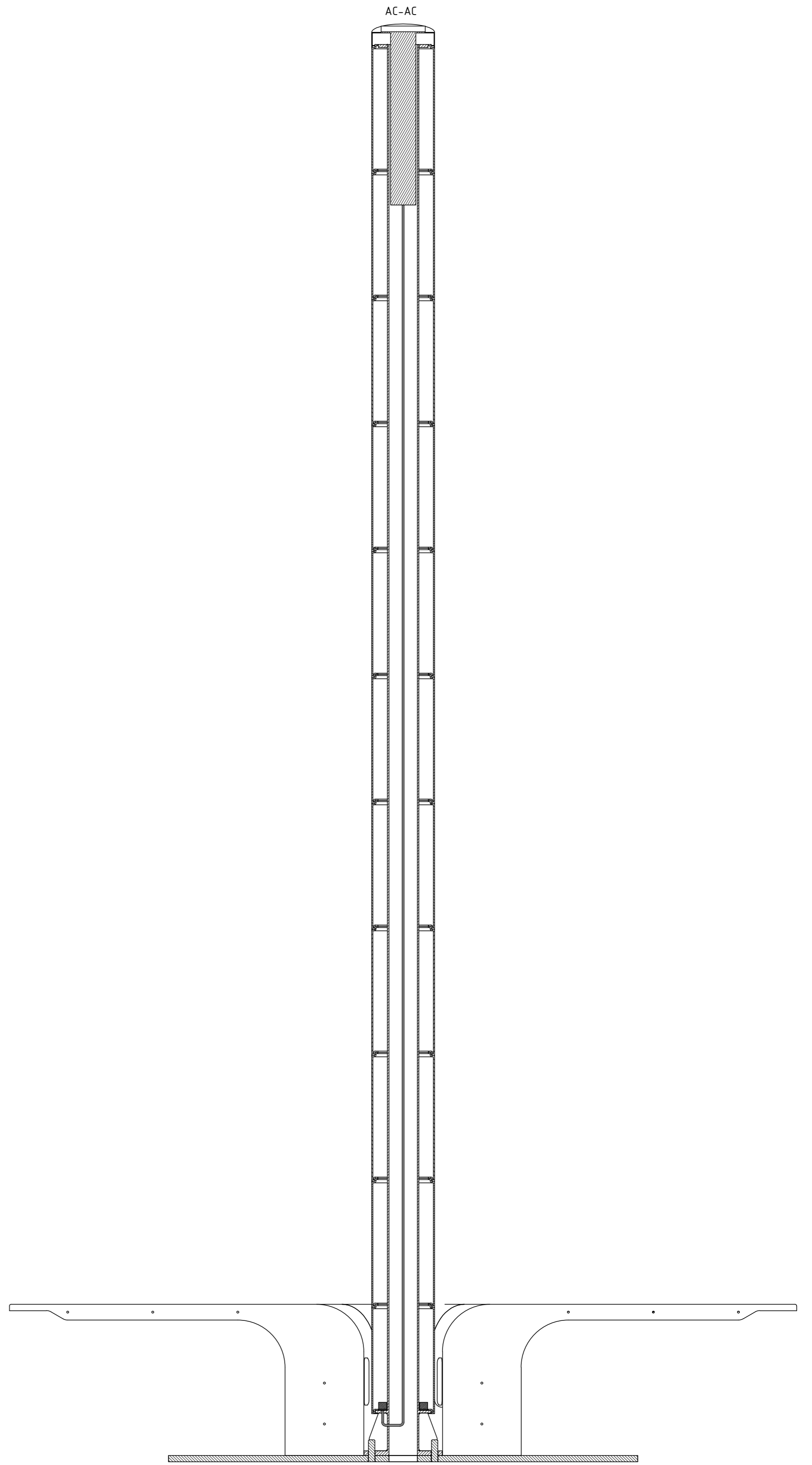
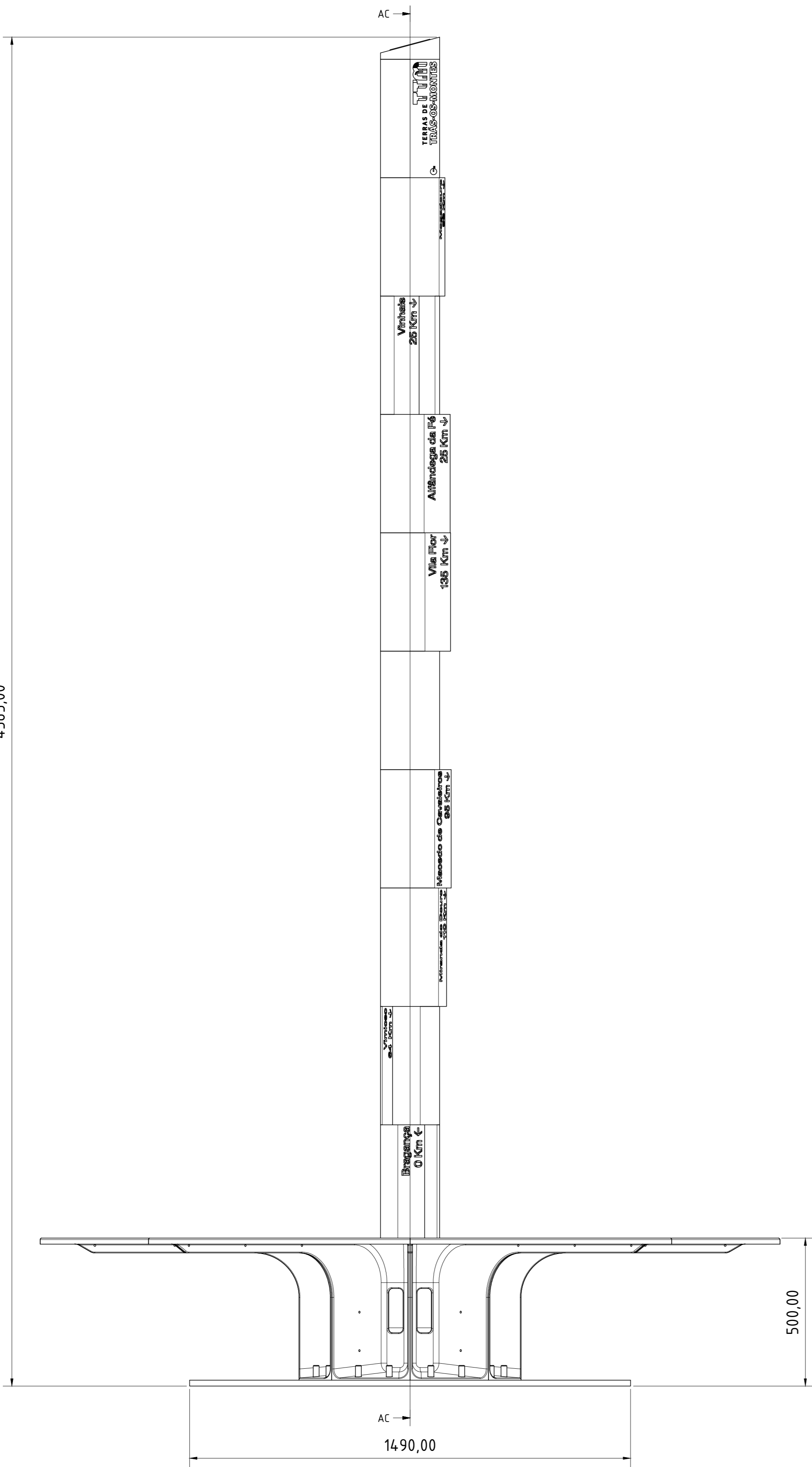

PROJ. CIM_TTM_o8	ESC. 1:10
DATA 04.10.23	TC Carlos Pereira
OBJ. Alçados	

